

**Licensing and Gambling Acts Sub-Committee**  
**12.8.14**

**APPLICATION FROM PROFOUND DECISIONS EVENT,  
BIDDLESDEN UNDER THE LICENSING ACT 2003 FOR A  
PREMISES LICENCE TO BE GRANTED (TIME LIMITED 1<sup>ST</sup>  
AUGUST 2014 – 14<sup>TH</sup> SEPTEMBER 2014)**

**1. THE APPLICATION**

Applicant(s): Profound Decisions LTD

Premises: Tournament Stud, Syresham Farm Fields Farm, Biddlesden,  
Buckinghamshire, NN13 5TR

**1.1 New Application**

The application is for a new Premises Licence under section 17 of the Act. The detail in respect to the hours and activities applied for are set out in the application form, attached as Appendix 1.

The steps the applicant intends to take to promote the licensing objectives are set out in the operating schedule (see appendix 1, Part P of application form). The applicant has produced an Event Management Plan which forms part of the operating schedule. This is subject to change and the final copy will be made available at the hearing. A copy of the current EMP is attached as Appendix 3.

In an effort to clarify the proposed permissions these are set out in Appendix 2. The applicant has provided various plans which are attached as Appendix 5. A location plan is attached as Appendix 6

Profound Decisions operate live role-playing events (LRP). LRP is a social activity where people portray historical and fantasy characters acting out roles. Similar to re-enactment in that people dress in costume and there are mock battles. The event comprises of a campsite, food concessions and a bar.

The licensing aspect of the event will run from 1800 – 0100 am on the Thursday and Friday and Saturday and Sunday 1100 – 0100 am and 1100 – 1500 on the Monday.

**2. RELEVANT REPRESENTATIONS**

**2.1 Responsible Authorities**

**Thames Valley Police – No representation**

**Environmental Health – No representation**



**Licensing Authority - No representation**  
**Bucks Fire and Rescue – No representation**  
**Planning – No representation**  
**Trading Standards – No comment**  
**Area Child Protection Committee – No comment**  
**Primary Health Care Trust – No comment**

## **2.2 Other Parties**

We received eleven representations during the consultation period from other parties. Copies of the representation are attached as Appendix 4.

### **3. NOTICE OF HEARING AND RESPONSES**

All parties were served Notices of Hearing on receipt of the representation along with the document, 'Licensing Act 2003 – The Procedure to be followed at Hearings'. The parties have therefore been notified of the consequences of failing to attend.

No further submissions have been received to date following service of the Notice of Hearing. Members will be notified of any further responses at the hearing.

### **4. GENERAL INFORMATION**

The general information Members need to have regard to when determining applications made under the Licensing Act 2003 is set out in a separate document which is attached to the Agenda under cover of which this report has been published.

### **5 ISSUES RAISED BY THE APPLICATION**

The issues raised by the application are for the Sub-Committee to determine having regard to all the relevant considerations. Whatever, the Sub-Committee decides, it must give reasons.

To assist Members and the parties further, The Licensing Services Manager will draw attention to any issues arising from this application at the hearing.

Contact Officer	Peter Seal 01296 585083
Background Documents	None





**Application for a premises licence to be granted under the Licensing Act 2003**

**PLEASE READ THE FOLLOWING INSTRUCTIONS FIRST**

Before completing this form please read the guidance notes at the end of the form. If you are completing this form by hand please write legibly in block capitals. In all cases ensure that your answers are inside the boxes and written in black ink. Use additional sheets if necessary.

You may wish to keep a copy of the completed form for your records.

I/we **PROFOUND DECISIONS LTD**

*(Insert name(s) of applicant)*

apply for a premises licence under section 17 of the Licensing Act 2003 for the premises described in Part 1 below (the premises) and I/we are making this application to you as the relevant licensing authority in accordance with section 12 of the Licensing Act 2003

**Part 1 - Premises Details**

Postal address of premises or, if none, ordnance survey map reference or description			
TOURNAMENT STUD SYRESHAM FIELDS FARM BIDDLESDEN BRACKLEY BUCKS			
Post town	BRACKLEY	Postcode	NN13 5TR
Telephone number at premises (if any)			
Non-domestic rateable value of premises		£ /	

**Part 2 - Applicant Details**

Please state whether you are applying for a premises licence as

Please tick as appropriate

- a) an individual or individuals \*  please complete section (A)
- b) a person other than an individual \*
  - i. as a limited company  please complete section (B)
  - ii. as a partnership  please complete section (B)
  - iii. as an unincorporated association or  please complete section (B)
  - iv. other (for example a statutory corporation)  please complete section (B)
- c) a recognised club  please complete section (B)
- d) a charity  please complete section (B)

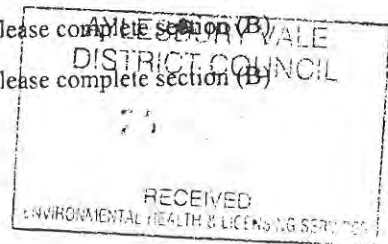

- e) the proprietor of an educational establishment  please complete section (B)
- f) a health service body  please complete section (B)
- g) a person who is registered under Part 2 of the Care Standards Act 2000 (c14) in respect of an independent hospital in Wales  please complete section (B)
- ga) a person who is registered under Chapter 2 of Part 1 of the Health and Social Care Act 2008 (within the meaning of that Part) in an independent hospital in England  please complete section (B)
- h) the chief officer of police of a police force in England and Wales  please complete section (B)

\* If you are applying as a person described in (a) or (b) please confirm:

Please tick yes

I am carrying on or proposing to carry on a business which involves the use of the premises for licensable activities; or

I am making the application pursuant to a

statutory function or

a function discharged by virtue of Her Majesty's prerogative

**(A) INDIVIDUAL APPLICANTS** (fill in as applicable)

S		
I		
C		
d		
ac		
P		
D		
E		
(0		

**SECOND INDIVIDUAL APPLICANT (if applicable)**

Mr <input type="checkbox"/>	Mrs <input type="checkbox"/>	Miss <input type="checkbox"/>	Ms <input type="checkbox"/>	Other Title (for example, Rev)	
Surname			First names		
I am 18 years old or over					<input type="checkbox"/> Please tick yes
Current postal address if different from premises address					
Post town			Postcode		
Daytime contact telephone number					
E-mail address (optional)					

**(B) OTHER APPLICANTS**

Please provide name and registered address of applicant in full. Where appropriate please give any registered number. In the case of a partnership or other joint venture (other than a body corporate), please give the name and address of each party concerned.

Name	PROFOUND DECISIONS LTD
Address	THORNTREES FARM 38 THORNTREES AVE LEA PRESTON PR2 1PJ
Registered number (where applicable)	04945345
Description of applicant (for example, partnership, company, unincorporated association etc.)	COMPANY
Telephone number (if any)	0845 0944 498
E-mail address (optional)	matt@profounddecisions.co.uk



**Part 3 Operating Schedule**

When do you want the premises licence to start?

DD MM YYYY  

0	1	0	8	2	0	1	4
---	---	---	---	---	---	---	---

If you wish the licence to be valid only for a limited period, when do you want it to end?

DD MM YYYY  

1	4	0	9	2	0	1	4
---	---	---	---	---	---	---	---

Please give a general description of the premises (please read guidance note 1)

Temporary canvas covered structure in the centre of the 'event field' at syresham fields farm, Biddenden. The building has wooden walls and is erected for events for provision of alcohol to event attendees. It is approximately 80ft x 30ft and holds a hundred people. The building is taken down when events are finished.

If 5,000 or more people are expected to attend the premises at any one time, please state the number expected to attend.

What licensable activities do you intend to carry on from the premises?

(Please see sections 1 and 14 of the Licensing Act 2003 and Schedules 1 and 2 to the Licensing Act 2003)

Provision of regulated entertainment

Please tick any that apply

- a) plays (if ticking yes, fill in box A)
- b) films (if ticking yes, fill in box B)
- c) indoor sporting events (if ticking yes, fill in box C)
- d) boxing or wrestling entertainment (if ticking yes, fill in box D)
- e) live music (if ticking yes, fill in box E)
- f) recorded music (if ticking yes, fill in box F)
- g) performances of dance (if ticking yes, fill in box G)
- h) anything of a similar description to that falling within (e), (f) or (g) (if ticking yes, fill in box H)



**Provision of late night refreshment** (if ticking yes, fill in box I)



**Supply of alcohol** (if ticking yes, fill in box J)

In all cases complete boxes K, L and M

A

Plays Standard days and timings (please read guidance note 6)			Will the performance of a play take place indoors or outdoors or both – please tick (please read guidance note 2)	Indoors	<input type="checkbox"/>
Day	Start	Finish		Outdoors	<input type="checkbox"/>
Mon			Please give further details here (please read guidance note 3)	Both	<input type="checkbox"/>
Tue					
Wed			State any seasonal variations for performing plays (please read guidance note 4)		
Thur					
Fri			Non standard timings. Where you intend to use the premises for the performance of plays at different times to those listed in the column on the left, please list (please read guidance note 5)		
Sat					
Sun					

**B**

<b>Films</b> Standard days and timings (please read guidance note 6)			<b>Will the exhibition of films take place indoors or outdoors or both – please tick</b> (please read guidance note 2)		Indoors <input type="checkbox"/>
					Outdoors <input type="checkbox"/>
					Both <input type="checkbox"/>
Day	Start	Finish	<b>Please give further details here</b> (please read guidance note 3)		
Mon					
Tue			<b>State any seasonal variations for the exhibition of films</b> (please read guidance note 4)		
Wed					
Thur			<b>Non standard timings. Where you intend to use the premises for the exhibition of films at different times to those listed in the column on the left, please list</b> (please read guidance note 5)		
Fri					
Sat					
Sun					

C

Indoor sporting events Standard days and timings (please read guidance note 6)			<b><u>Please give further details</u></b> (please read guidance note 3)
Day	Start	Finish	
Mon			
Tue			
Wed			
Thur			
Fri			
Sat			
Sun			

**State any seasonal variations for indoor sporting events** (please read guidance note 4)

**Non standard timings. Where you intend to use the premises for indoor sporting events at different times to those listed in the column on the left, please list** (please read guidance note 5)

**D**

Boxing or wrestling entertainments Standard days and timings (please read guidance note 6)			Will the boxing or wrestling entertainment take place indoors or outdoors or both – please tick (please read guidance note 2)	Indoors	<input type="checkbox"/>
Day	Start	Finish		Outdoors	<input type="checkbox"/>
Mon			<b>Please give further details here</b> (please read guidance note 3)	Both	<input type="checkbox"/>
Tue					
Wed			<b>State any seasonal variations for boxing or wrestling entertainment</b> (please read guidance note 4)		
Thur					
Fri			<b>Non standard timings. Where you intend to use the premises for boxing or wrestling entertainment at different times to those listed in the column on the left, please list</b> (please read guidance note 5)		
Sat					
Sun					



**F**

Recorded music Standard days and timings (please read guidance note 6)			Will the playing of recorded music take place <u>indoors or outdoors or both – please tick</u> (please read guidance note 2)	Indoors	<input type="checkbox"/>
Day	Start	Finish		Outdoors	<input type="checkbox"/>
Mon			<b>Please give further details here</b> (please read guidance note 3)	Both	<input type="checkbox"/>
Tue					
Wed					
Thur			<b>State any seasonal variations for the playing of recorded music</b> (please read guidance note 4)		
Fri					
Sat			<b>Non standard timings. Where you intend to use the premises for the playing of recorded music at different times to those listed in the column on the left, please list</b> (please read guidance note 5)		
Sun					

E

Live music Standard days and timings (please read guidance note 6)			Will the performance of live music take place indoors or outdoors or both – please tick (please read guidance note 2)	Indoors	<input checked="" type="checkbox"/>
Day	Start	Finish		Outdoors	<input type="checkbox"/>
Mon	11:00	15:00	<p><b>Please give further details here</b> (please read guidance note 3)</p> <p>Music performed by volunteers using historical instruments such as harps &amp; flutes. No amplification of any kind will be used ever.</p> <p><b>State any seasonal variations for the performance of live music</b> (please read guidance note 4)</p> <p><b>Non standard timings. Where you intend to use the premises for the performance of live music at different times to those listed in the column on the left, please list</b> (please read guidance note 5)</p>	Both	<input type="checkbox"/>
Tue					
Wed					
Thur	18:00	01:00			
Fri	18:00	01:00			
Sat	11:00	01:00			
Sun	11:00	01:00			

G

<b>Performances of dance</b> Standard days and timings (please read guidance note 6)			<b>Will the performance of dance take place indoors or outdoors or both – please tick</b> (please read guidance note 2)			
			Indoors	<input type="checkbox"/>		
			Outdoors	<input type="checkbox"/>		
			Both	<input type="checkbox"/>		
Day	Start	Finish	<b>Please give further details here</b> (please read guidance note 3)			
Mon						
Tue						
Wed					<b>State any seasonal variations for the performance of dance</b> (please read guidance note 4)	
Thur						
Fri						
Sat					<b>Non standard timings. Where you intend to use the premises for the performance of dance at different times to those listed in the column on the left, please list</b> (please read guidance note 5)	
Sun						

H

<p><b>Anything of a similar description to that falling within (e), (f) or (g)</b> Standard days and timings (please read guidance note 6)</p>			<p>Please give a description of the type of entertainment you will be providing</p>		
Day	Start	Finish	<p><b><u>Will this entertainment take place indoors or outdoors or both – please tick</u></b> (please read guidance note 2)</p>	Indoors	<input type="checkbox"/>
Mon				Outdoors	<input type="checkbox"/>
				Both	<input type="checkbox"/>
Tue			<p><b><u>Please give further details here</u></b> (please read guidance note 3)</p>		
Wed					
Thur			<p><b><u>State any seasonal variations for entertainment of a similar description to that falling within (e), (f) or (g)</u></b> (please read guidance note 4)</p>		
Fri					
Sat			<p><b><u>Non standard timings. Where you intend to use the premises for the entertainment of a similar description to that falling within (e), (f) or (g) at different times to those listed in the column on the left, please list</u></b> (please read guidance note 5)</p>		
Sun					

1

Late night refreshment Standard days and timings (please read guidance note 6)			Will the provision of late night refreshment take place indoors or outdoors or both – please tick (please read guidance note 2)	Indoors	<input type="checkbox"/>
Day	Start	Finish		Outdoors	<input type="checkbox"/>
				Both	<input checked="" type="checkbox"/>
Mon	11:00	15:00	<b>Please give further details here</b> (please read guidance note 3) REFRESHMENTS PROVIDED BY FOUR SUBCONTRACTORS FEAST, TYKES, MHORISH, RIGHT WOK - USING THEIR OWN PREMISES.		
Tue					
Wed			<b>State any seasonal variations for the provision of late night refreshment</b> (please read guidance note 4)		
Thur	18:00	01:00	<b>Non standard timings. Where you intend to use the premises for the provision of late night refreshment at different times, to those listed in the column on the left, please list</b> (please read guidance note 5)		
Fri	<del>18:00</del> 09:00	<del>01:00</del> 01:00			
Sat	09:00	01:00			
Sun	09:00	01:00			



J

<b>Supply of alcohol</b> Standard days and timings (please read guidance note 6)			<b>Will the supply of alcohol be for consumption – please tick</b> (please read guidance note 7)	On the premises <input type="checkbox"/>
				Off the premises <input type="checkbox"/>
Day	Start	Finish		Both <input checked="" type="checkbox"/>
Mon	11:00	15:00	<b>State any seasonal variations for the supply of alcohol</b> (please read guidance note 4)	
Tue				
Wed				
Thur	18:00	01:00	<b>Non standard timings. Where you intend to use the premises for the supply of alcohol at different times to those listed in the column on the left, please list</b> (please read guidance note 5)	
Fri	18:00	01:00		
Sat	11:00	01:00		
Sun	11:00	01:00		

State the name and details of the individual whom you wish to specify on the licence as designated premises supervisor:

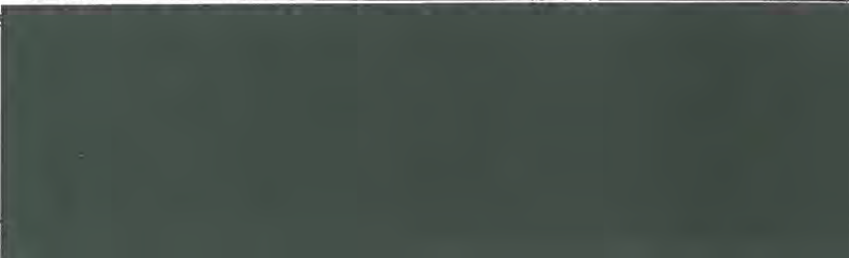
Name	MATTHEW PENNINGTON
Address	
Postcode	
Personal licence number (if known)	PRPA0450
Issuing licensing authority (if known)	PRESTON CITY COUNCIL

K

Please highlight any adult entertainment or services, activities, other entertainment or matters ancillary to the use of the premises that may give rise to concern in respect of children (please read guidance note 8).

L

Hours premises are open to the public Standard days and timings (please read guidance note 6)			State any seasonal variations (please read guidance note 4)
Day	Start	Finish	
Mon	10:00	15:00	<p><b>Non standard timings. Where you intend the premises to be open to the public at different times from those listed in the column on the left, please list</b> (please read guidance note 5)</p>
Tue			
Wed			
Thur	18:00	01:00	
Fri	10:00	01:00	
Sat	10:00	01:00	
Sun	10:00	01:00	

**M** Describe the steps you intend to take to promote the four licensing objectives:

**a) General – all four licensing objectives (b, c, d and e) (please read guidance note 9)**

We maintain a database of name & address of every event participant. Access to the premises is only permitted to event attendees.  
Our event management plan is inline with these licensing objectives - it is distributed to all senior staff.

**b) The prevention of crime and disorder**

We utilize a team of security staff who are SIA registered and have the support of a team of marshalls.  
All bar staff are instructed not to serve individuals who are inebriated.

**c) Public safety**

We only serve drinks in plastic glasses. We do not use glass containers or serve beer or alchopops in glass bottles.

**d) The prevention of public nuisance**

Event attendees remain on site each evening; there is no interaction between customers of the premises and local residents.

**e) The protection of children from harm**



We operate a challenge 25 policy. Children under 16 may only attend with a parent or guardian.

**Checklist:**

Please tick to indicate agreement

- I have made or enclosed payment of the fee.
- I have enclosed the plan of the premises.
- I have sent copies of this application and the plan to responsible authorities and others where applicable.
- I have enclosed the consent form completed by the individual I wish to be designated premises supervisor, if applicable.
- I understand that I must now advertise my application.
- I understand that if I do not comply with the above requirements my application will be rejected.

**IT IS AN OFFENCE, LIABLE ON SUMMARY CONVICTION TO A FINE NOT EXCEEDING LEVEL 5 ON THE STANDARD SCALE, UNDER SECTION 158 OF THE LICENSING ACT 2003, TO MAKE A FALSE STATEMENT IN OR IN CONNECTION WITH THIS APPLICATION.**

**Part 4 – Signatures** (please read guidance note 10)

**Signature of applicant or applicant’s solicitor or other duly authorised agent** (see guidance note 11).  
**If signing on behalf of the applicant, please state in what capacity.**

Signature		
Date	23/6/14	
Capacity	Company Director	

**For joint applications, signature of 2<sup>nd</sup> applicant or 2<sup>nd</sup> applicant’s solicitor or other authorised agent** (please read guidance note 12). **If signing on behalf of the applicant, please state in what capacity.**

Signature	
Date	
Capacity	

Contact name (where not previously given) and postal address for correspondence associated with this application (please read guidance note 13) Matthew Pennington Thorntrees Farm Thorntrees Ave, Lea, Preston Lancs			
Post town	<del>PR2</del> <del>IP3</del> PRESTON	Postcode	<del>PR2</del> <del>IP3</del>
Telephone number (if any)	0845 0944798		
If you would prefer us to correspond with you by e-mail, your e-mail address (optional) matt@Profounddecisions.co.uk			

**Data Protection**

AVDC is a Data Controller under the Data Protection Act 1998. We hold information for the purposes specified in our notification to the Information Commissioner and may use this information for any of them. We may receive information about you from other organisations, or we may give information to them. If we do it will only be as the law permits, to check the accuracy of information, to prevent fraud or detect crime, or to protect public funds.

**Notes for Guidance**

1. Describe the premises, for example the type of premises, its general situation and layout and any other information which could be relevant to the licensing objectives. Where your application includes off-supplies of alcohol and you intend to provide a place for consumption of these off-supplies, you must include a description of where the place will be and its proximity to the premises.
2. Where taking place in a building or other structure please tick as appropriate (indoors may include a tent).
3. For example the type of activity to be authorised, if not already stated, and give relevant further details, for example (but not exclusively) whether or not music will be amplified or unamplified.
4. For example (but not exclusively), where the activity will occur on additional days during the summer months.
5. For example (but not exclusively), where you wish the activity to go on longer on a particular day e.g. Christmas Eve.
6. Please give timings in 24 hour clock (e.g. 16:00) and only give details for the days of the week when you intend the premises to be used for the activity.
7. If you wish people to be able to consume alcohol on the premises, please tick 'on the premises'. If you wish people to be able to purchase alcohol to consume away from the premises, please tick 'off the premises'. If you wish people to be able to do both, please tick 'both'.
8. Please give information about anything intended to occur at the premises or ancillary to the use of the premises which may give rise to concern in respect of children, regardless of whether you intend children to have access to the premises, for example (but not exclusively) nudity or semi-nudity, films for restricted age groups or the presence of gaming machines.
9. Please list here steps you will take to promote all four licensing objectives together.
10. The application form must be signed.
11. An applicant's agent (for example solicitor) may sign the form on their behalf provided that they have actual authority to do so.
12. Where there is more than one applicant, each of the applicant or their respective agent must sign the application form.
13. This is the address which we shall use to correspond with you about this application.

Consent of individual to being specified as premises supervisor

MATTHEW IAN PENNINGTON

[full name of prospective premises supervisor]

of

SYRESHAM FIELDS FARM  
[Redacted address]

hereby confirm that I give my consent to be specified as the designated premises supervisor in relation to the application for

PREMISES LICENCE

[type of application]

by

PROFOUND DECISIONS LTD

[name of applicant]

relating to a premises licence

[number of existing licence, if any]

for

TOURNAMENT STUD  
SYRESHAM FIELDS FARM  
BIDDOLESDEN  
BRACKLEY  
NN13 5TR

[name and address of premises to which the application relates]



and any premises licence to be granted or varied in respect of this application made by

PROFOUND DECISIONS LTD  
*[name of applicant]*

concerning the supply of alcohol at

TOURNAMENT STUO  
SYRESHAM FIELDS FARM  
BIDDLESDEN  
BRACKLEY  
NN13 5TR

*[name and address of premises to which application relates]*

I also confirm that I am applying for, intend to apply for or currently hold a personal licence, details of which I set out below.

Personal licence number

PRPA0450

*[insert personal licence number, if any]*

Personal licence issuing authority

PRESTON CITY COUNCIL

*[insert name and address and telephone number of personal licence issuing authority, if any]*

Signed



Name (please print)

MATTHEW PENNINGTON

Date

23/6/14

**The application is for the sale of alcohol and the provision of regulated entertainment**

Sale by retail of alcohol (Both)				
	Existing		Proposed	
	From	To	From	To
	Monday	N/A	N/A	11 00
Tuesday	N/A	N/A	N/A	N/A
Wednesday	N/A	N/A	N/A	N/A
Thursday	N/A	N/A	18 00	01 00
Friday	N/A	N/A	18 00	01 00
Saturday	N/A	N/A	11 00	01 00
Sunday	N/A	N/A	11 00	01 00

Live Music (Indoors)				
	Existing		Proposed	
	From	To	From	To
	Monday	N/A	N/A	11 00
Tuesday	N/A	N/A	N/A	N/A
Wednesday	N/A	N/A	N/A	N/A
Thursday	N/A	N/A	18 00	01 00
Friday	N/A	N/A	18 00	01 00
Saturday	N/A	N/A	11 00	01 00
Sunday	N/A	N/A	11 00	01 00

Late Night Refreshment (Both)				
	Existing		Proposed	
	From	To	From	To
	Monday	N/A	N/A	N/A
Tuesday	N/A	N/A	N/A	N/A
Wednesday	N/A	N/A	N/A	N/A
Thursday	N/A	N/A	23 00	01 00
Friday	N/A	N/A	23 00	01 00
Saturday	N/A	N/A	23 00	01 00
Sunday	N/A	N/A	23 00	01 00

Opening Hours				
	Existing		Proposed	
	From	To	From	To
	Monday	N/A	N/A	10 00
Tuesday	N/A	N/A	N/A	N/A
Wednesday	N/A	N/A	N/A	N/A
Thursday	N/A	N/A	18 00	01 00
Friday	N/A	N/A	10 00	01 00
Saturday	N/A	N/A	10 00	01 00
Sunday	N/A	N/A	10 00	01 00

BLANK PAGE



# Profound Decisions Event Management

Version 3.8  
Last updated: 13<sup>th</sup> March 2014







1. Precis	3	13. Evacuation	13
Nature of the Events	3	14. Fireworks	14
Nature of the Company	3	15. Fire Safety	14
Nature of the Participants	3	16. Police	14
2. Planning Permission	4	17. Food Hygiene	14
Wargames	4	Facilities	14
28 Day Limit	4	18. Environmental Issues	15
3. Licensing	4	Local Community Issues	15
License Holder	5	Waste Management	15
Protection of Minors	5	Traffic Management	15
Security Issues	5	Power	15
Public Nuisance	5	Noise	16
4. Highways	6	Weather	16
Reception	6	Heat	16
Road Closures	6	Wind	16
Road Signs	6	Cold	17
Parking	7		
5. Risk Assessment	7		
6. Insurance	7		
7. First Aid	7		
8. Children & Vulnerable Persons	8		
DBS Checks	8		
9. Stewards and Marshals	9		
Risk Assessment	9		
Visibility	10		
Site Layout	10		
10. Camping Considerations	10		
Land	10		
Water	10		
Sanitation	11		
Refuse Disposal	11		
Fire Safety	11		
11. Temporary Structures	12		
12. Communications	12		
Event Volunteers	12		
Press/Media	12		
The Public	13		





# 1. PRECIS

## **Nature of the Events**

Profound Decisions operate live role-playing events. LRP is a social activity where people portray historical and fantastic characters acting out the role. It is visually similar to re-enactment, in that people dress in costume and there are occasional mock battles, but we use foam weapons to avoid the safety considerations with steel weapons. It is thematically similar to online roleplaying games like World of Warcraft.

Events are unstructured, participants wander freely around the site visiting stalls, attractions and each others camps. On two days there are large actively managed battles, but at other times there are effectively no structured activities.

Members of the management team are on call from 8am in the morning until 1am that night. Our security team operate throughout the night, with myself available on call throughout the night in the event of an incident.

## **Nature of the Company**

Profound Decisions is a small family-run business with just three employees. We have been managing commercial live roleplaying events very successfully since 2004 and have produced over forty events during that period with attendances of over a thousand people at the largest events. The three employees form the core management team for events providing coordination and direction to all our volunteers.

The events are supported by a large team of around 300 regular volunteers. Our volunteers tend to be very loyal, and the majority have been volunteering as part of our event team for many years, as well as serving as members of volunteer teams for other events.

## **Nature of the Participants**

Ninety percent of all event attendees are repeat event goers - the bulk of people attending our events are doing so on the basis of aiming to attend every event we put on. In addition, the live role-playing hobby is a very small and tight-knit community. Our customer base is drawn from this community and there is a clear, shared, understanding of acceptable behaviour. Attendees know that unacceptable behaviour can lead to exclusion and this is a serious threat in this social context. Our customers know us and they know each other and as a result we have never experienced any meaningful security issues over the decade that we have been operating.

Because our customer base is drawn from the live roleplaying hobby the overwhelming



majority of them are familiar with the safety protocols put in place for all British live roleplaying events. This means if someone calls “Man Down” then every experienced participant will immediately stop what they are doing and look for the source of the call. When they see it, they move away from the area to allow emergency access and await further instruction. These common safety procedures make it vastly easier to safely manage participants at events in the case of an emergency.

Therefore crowd control mechanisms are institutional for our hobby and are well drilled and practiced regularly by all regular participants.

## 2. PLANNING PERMISSION

There are no permanent structures associated with our events, and we are not aware of any of our activities that would require a planning application. Instead we operate our events from the fields of Syresham Fields Farm in Biddlesdon, under the permitted development rights of the Town, Country and City Planning (General Permitted Development) Order 1995. We are preparing to submit a change of use application for an a small section of the farm where currently our equipment is stored between events.

### **Wargames**

Our activities include wargames, as detailed in Part 4, Class B.3 of the 1995 act. However there are no sites of special scientific interest on or near the farm and therefore the restrictions on permitted development rights for wargames are not applicable.

### **28 Day Limit**

We take care to minimize set-up and take-down periods; we do not permit anybody to arrive on site more than twenty-four hours before an event begins and all attendees are required to leave site before 7pm of the last day of an event. This helps to ensure that we do not breach the twenty-eight day limit for temporary use of the land.

## 3. LICENSING

Many of our event attendees bring their own food and drink, preferring to remain in their camps and socialize there. We operate a bar on site, with premises large enough for up to two hundred people at any one time. Following the recommendation of the licensing authority we have instructed all our caterers to stop serving food before 23:00, to ensure that their activities do not need to be regulated. Our security patrols check that the onsite caterers are complying with this requirement.





## License Holder

I (Matthew Ian Pennington) am a personal license holder (PRPA0450). My license is valid until the 28th March 2016. In addition to myself there is always at least one member of the volunteer crew who is also a personal license holder operating the bar at all times.

## Protection of Minors

Our events are attended by families who are welcome in our bar area, which is a hub of social activity in the game. We operate a “challenge-25” policy for anyone purchasing licensed drinks. We only use crew with existing experience in bar work and all crew receive basic induction to reaffirm the nature and importance of the challenge-25 policy. We do not tolerate under-age alcohol abuse; all minors who attend our events are warned that they face permanent exclusion from further events if they attempt to purchase licensed drinks from the bar.

## Security Issues

Our bar crew are given clear instructions to refuse to serve any customers who are becoming heavily inebriated or whose drinking is affecting their ability to remain relaxed and sociable. There is a strong focus on social interaction at our events, attendees are there to actively play a game co-operatively with others, not to become intoxicated and passively watch. As a result consumption levels are lower than for equivalent sized events.

Our event policies allow us to permanently refuse entry to any individual. A relaxed social atmosphere is essential to the character of our events and we would take all possible steps to protect it. If we ever have an incident where alcohol provokes a serious confrontation or affray or presents a safety risk to other participants, then we would ban those responsible. However this has *never* occurred at any forty-plus events that we have run over the last decade.

## Public Nuisance

There is little movement on or off the site, especially in the evening when the bar is open. The majority of attendees camp for the weekend and leave only to make irregular visits to local shops. Our events are always held on private land. The aim of the events is to encourage immersion and remove modern distractions, so we are keen to chose locations as far from local residents as is reasonably possible.

All of our attendees are aware that causing a public nuisance would damage the reputation of the event and of their hobby. They are also aware that we would not tolerate that behaviour and it would result in a permanent ban from future events. As a



result we have never had a public nuisance incident.

## 4. HIGHWAYS

Our events are held at Tournament Stud, which is physically adjacent to the Silverstone Grand Prix circuit. The entrance to the site is approximately 800 metres from the sliproad exit from the A43 which runs past the site. Event attendees stagger their attendance throughout the event, so peak traffic volumes are only a fraction of the total attendance. We strongly encourage event attendees to travel to the event by public transport.

As a result we have operated our events at this site since 2010 without any evidence that our events have caused any impact on other road users in the area.

### Reception

The site enjoys excellent access to the connecting road with an exit wide enough for the largest farm machinery to enter or leave easily in either direction. As a result our attendees have no problems leaving the road and entering the site safely.

Reception is handed by the marshals in our security team who receive visitors at a small tent (sometimes caravan) which is positioned at least 50 metres from the entrance to the site. Training for the volunteers on the gate includes clear instruction on the processes of operating the gate with an emphasis on the need to prevent a backlog forming that could impact the road that leads to the farm.

If a backlog does start to form, volunteers are trained to instruct all cars to move off the farm road to wait on the adjacent fields. This ensures that the farm road and entrance remains accessible to vehicles arriving at the site at all times. The security crew on the gate are equipped with radios in case they need to request assistance during busy times.

### Road Closures

Our events are held on private land so there is no need to close any roads.

### Road Signs

We issue all event attendees with maps indicating the location of the site. As already stated the overwhelming majority of our event attendees have attended one of our events before and so they are already familiar with the route to site.

We don't advertise to the general public and have no interest in attracting "passing trade". As a result we do not place signs that indicate the presence or direction of our





event. None of our players report significant difficulty finding the site and the entrance to Syresham Fields Farm is already signposted, to allow drivers to identify it.

## Parking

All cars are parked on site and there is sufficient space for all potential attendees; nobody is permitted to park on the adjoining roads. Our security team provide the event-goers with simple instructions on how and where to park their car to ensure efficient and safe parking.

## 5. RISK ASSESSMENT

Live roleplaying may involve controlled and limited physical contact, similar to mild contact sports and wargame activities with mock fights and battles taking place at events. We hold specific risk assessments for this aspect of the event.

Copies of all our current risk assessments, along with risk reduction strategies adopted are found in the separate document on risk management.

## 6. INSURANCE

Profound Decisions events are insured through an umbrella insurance policy organized for the live roleplaying hobby. This is essential as it provides coverage for the unique risks involved for events that include mock battles of the kind we operate. The policy is reviewed annually to ensure that it continues to meet our needs in terms of level of attendance allowed and level of cover provided.

Our insurance policy includes £10,000,000 of employee liability insurance and £5,000,000 of product liability and public liability. The policy is arranged through Cover-ex International who provide specialist events insurance.

## 7. FIRST AID

From 2013 onwards first-aid provision for our events is being provided by RL Medical Services operated by Richard Lamb. Richard's team have specialist experience in providing medical cover for live roleplaying events built up over a ten-year period.

Richard's team have conducted a medical risk assessment of the events and indicated the level of medical provision that is required. We are satisfied that their assessments meet guidelines for the appropriate level of cover and concurs with our assessments of the risks involved.



## 8. CHILDREN & VULNERABLE PERSONS

Live role-playing is an exciting and appealing hobby for children and they are welcome to attend some of our events as part of family groups. Live role-playing is not a suitable hobby for vulnerable adults, it requires a large degree of social engagement by the participants, independent action initiated by individuals and requires participants to clearly understand boundaries between the game and real life. As such the activity is not something that would appeal to vulnerable adults and I am not aware of any vulnerable adults who participate.

As a result the main focus of our policies is the care and protection of children. We have extensive guidelines for all event volunteers and event attendees as well as guidelines for parents bringing children to events and guidelines for children themselves. Rather than cut and paste these guidelines into this document I have provided links to the relevant documents on our public wiki - a website frequented and used by all event attendees.

General guidelines:

<http://empire.crew.profounddecisions.co.uk/empire-wiki/Children>

Parental guidelines:

[http://empire.crew.profounddecisions.co.uk/empire-wiki/Guidelines\\_for\\_parents\\_or\\_carers](http://empire.crew.profounddecisions.co.uk/empire-wiki/Guidelines_for_parents_or_carers)

Children's Guidelines:

[http://empire.crew.profounddecisions.co.uk/empire-wiki/Guidelines\\_for\\_all\\_young\\_live\\_roleplayers](http://empire.crew.profounddecisions.co.uk/empire-wiki/Guidelines_for_all_young_live_roleplayers)

Child Protection Policy:

[http://empire.crew.profounddecisions.co.uk/empire-wiki/Child\\_protection\\_information](http://empire.crew.profounddecisions.co.uk/empire-wiki/Child_protection_information)

### DBS Checks

After consultation with the DBS, they have informed us that we are not eligible to register to conduct DBS checks on the crew managing our events. This is because our crew are clearly instructed not to spend time alone with children and parents are aware that our events do not provide opportunities to leave children in our care. Parents remain responsible for their children throughout the events.

As a result we are not permitted to require DBS checks of our crew, as they are unnecessary and thus represent an invasion of privacy.

Therefore we instead use character references and evidence that individuals are employed in industries that do require DBS checks when selecting crew who provide activities aimed at children (although parents remain present throughout). Essentially





we choose crew who come well recommended, have a good standing in the community and are employed as teachers or in similar roles.

## 9. STEWARDS AND MARSHALS

Rick Clarke is our event steward and the head of our event security team. He SIA registered. Gavin Waller, a senior member of the team has completed the SIA course and we are helping him sort SIA registration. They provide supervision to a team of eight marshals who arrange event security throughout. In addition to these numbers, our stewards are able to call on our team of 14 game referees during the day when the game is taking place. Our marshals and referees receive a full briefing from Rick before the start of every event, so that they are clear on their responsibilities and on the boundaries of their responsibilities and powers.

The briefing includes what to do if faced by a fire, the location of first aid and event administration facilities, radio protocol and contacting the event management team including when and how to escalate issues and how to handle lost children procedures and record them.

Our events are open-air and do not include any crowd control mechanisms. We don't direct participants as they move around the site and there are no barriers restricting entry or exit to any areas. Participants self-organize and do not crowd closely together except during battles. As a result we do not have a high emphasis on evacuation procedures.

Our referees do have an extensive briefing on handling battlefield emergencies and injuries with a focus on bringing the game to a stop quickly and efficiently to allow paramedics immediate access.

These procedures use the standard "Man Down" mechanism that is adopted as best practice right across the hobby and is well known to almost all participants. Live role-players who hear this call will instinctively stop what they are doing. Those who are close enough to the incident that provoked the call will move far enough away to allow our first-aid team swift access. The game resumes once the incident has been handled safely and a call of "Time-In" is given.

Marshals and referees are not briefed on visitor or audience profile, as they are all experienced individuals drawn from the live role-playing hobby. As a result they are already very familiar with the size and make-up of our events.

### **Risk Assessment**

A formal assessment of the risks associated with marshalling the events has been carried out and is included with our risk assessment documents. As noted earlier, the number



of volunteers on the security team is low, but this reflects the reduced risks associated with an event that has regular participation by the same individuals and a long history right across the national hobby of having zero security incidents due to the small and tight-knit community involved.

## Visibility

Rick and the marshals use standard yellow high-visibility jackets to allow them to be easily identified. They operate from a security tent which is manned throughout the night and is clearly labelled with a large vinyl banner.

## Site Layout

All attendees are given a plan of the site in their booking information that includes the location of event administration and security facilities.

# 10. CAMPING CONSIDERATIONS

Many of our event attendees choose to attend the event on more than one day and camp on site, rather than using local hostelries. As a result we adopt guidelines and procedures inline with those recommended by the camping and caravanning society (<http://www.campingandcaravanningclub.co.uk/ukcampsites/smallsites/runasite/campsite-requirements/>)

## Land

Our rental agreement with Tournament Stud gives us exclusive access to the fields used for the event throughout the year. These fields are referred to as the exhibition fields and by agreement with us they are not used by the farm to grow silage, nor grazed by animals.

The land is not flat, but it is level with a gentle slope that facilitates drainage but does not affect tents or participants. There are no pylons, ponds or rivers, but the site does have some ditches that run alongside the hedgerows. Event attendees are instructed to avoid these ditches and there is no reason for anyone to have to enter them.

## Water

The fresh water supply for the event is drawn directly from the mains supply provided by the local water utility that serves the farm. The site has clean drinking water taps installed at regular intervals around circumference of the exhibition fields. These taps are labelled to indicate that they provide drinking water.





## Sanitation

Tournament Stud exhibition field has a small installed toilet block. This contains three toilets for use by gents, one toilet for use by women and two urinals.

We own our own flushing toilet systems which are installed on site for the duration of each event. These provide seven toilets and four urinals for use by gents and five toilets for use by women. Waste from these toilets is collected in a holding tank and collected regularly by Grundons waste management.

The on-site block and our additional facilities all have several hand basins with running water and are well lit night and day. Toilets are inspected three times a day to ensure that there is an adequate supply of toilet roll, hand towels and soaps.

In addition to these facilities we own fourteen portaloos which are installed around the site for quick access by event attendees. We own equipment for servicing these facilities, allowing us to remove the waste and clean and refresh the facilities daily.

For the Easter event we have hired four additional recirculation toilet blocks from a local event hire company. These provide an additional eight toilets and sixteen urinals for use by gents and sixteen toilets for use by women.

This means we have a total sanitation provision of fourteen unisex portaloos, 22 cubicles for women and 18 cubicles and 22 urinals for gents. From regular experience we know that this number is sufficient to meet the requirements of our event attendees.

## Refuse Disposal

Refuse disposal is arranged by contract with a local waste management company, Dial-a-bin. For our events this year we have booked two large roll-on roll-off twenty cubic yard skips. These are stored on site and removed at the end of the weekend by them with waste disposal certificates provided.

To facilitate the collection of rubbish we use “pop-up” green plastic bins which are distributed around the site and lined with black bin-liners. These are emptied regularly into the large skips which are then collected after the event.

## Fire Safety

There are fire safety points arranged on the site so that those people who are camping have adequate provision, in line with the risk assessments conducted by us. These points include basic fire-fighting equipment and the means to raise the alarm.

Adequate access to the site is maintained at all times so that all emergency services can



enter the site without difficulty or delay. Our campers are encouraged to camp adjacent to their vehicles in pairs of rows that are at least 4m apart. The separation allows traffic and emergency vehicles to drive between rows of tents.

Alternating parked cars with tents means that event attendees have easy access to a securely locked space. It also serves to increase separation between tents, which might otherwise be pitched too close together.

## 11. TEMPORARY STRUCTURES

The overwhelming majority of our event takes place without the use of temporary structures. Event attendees bring their own tents and the event takes place as players move amongst them. We do not use stages or any equipment that is erected on site of that kind.

We do have eight units of temporary seating or shelter large enough to house thirty people. These are manufactured to our requirements by a workshop in Preston and deployed on site prior to the event. Our security team and game referees are briefed on the capacity of these structures, and work with other event volunteers operating in the areas around the structures to ensure that they do not become overloaded.

## 12. COMMUNICATIONS

### Event Volunteers

We have extensive Facebook networks that we use to communicate with our volunteers on the six months of preparation for an event. They have resources made available to them, including crew guidelines outlining what is expected of them, volunteers with safety related responsibilities also read the risk assessments for the event.

At events we hire 90 two-way radios from Radiotek in Birmingham. These are licensed for the power and bandwidth used by us. We enforce strict radio protocol to keep channels clear for emergency traffic. Separate channels are allocated for the security team (which includes stewards, marshals and those manning the gate), for first-aid, for game referees and for the event administration team. Covert headsets are provided to all teams handling sensitive information.

### Press/Media

We do not communicate with the local press or media in anyway. Our event is sufficiently small that it does not substantially impact local residents so nobody needs to know our event is on, except the people attending. Our assessment is that the inclusion of the





media in our event organisation would not bring any identifiable safety improvements but would be to the detriment of many of those who attend.

We have full contact details for everyone who books to attend our events and are able to communicate rapidly using emails with our entire customer base in the event of an emergency such as a cancellation. The close-knit nature but geographically disparate nature of the community means that local media would reach less than 3% of our participants, but messages placed on key internet forums, combined with emails can reach over 90% of our participants within hours.

## **The Public**

All our events are advertised only within the live role-playing community. By keeping the events private in this way we avoid many issues associated with events open to the general public, minimizing the need for publicity and considerably reducing security concerns. Our goal is to be invisible to the local community, before, during and after our events have taken place.

Where there are local community representatives then we look to address specific issues or concerns with them. For instance in 2012 we were asked by our event attendees if they could hold a party to celebrate the tenth anniversary of the game. We discussed this issue with members of the local parish council, who expressed concerns about potential noise. As a result the plans were dropped.

## **13. EVACUATION**

As stated earlier, we do not operate any form of physical barriers or crowd control at our events. There are no stages for performers, there is no central location or entertainment that attendees would naturally push forwards to see. The nature of our events is one where attendees choose to wander around the site, interacting with other attendees on a one-to-one basis.

The site is open on three sides, anyone can wander in or out. Our events are of negligible interest to the local public and we do not advertize locally in anyway, there is no provision for spectators and nothing to see - our events are for participants only. As a result we have no need for any form of physical controls to prevent people entering or leaving the site, or any areas on it that we are operating from. Areas intended for the volunteers only are demarcated using thin tape. It is information only and has no capacity to restrict physical movement.

These policies are in line with our risk assessments and our lengthy experience of running commercial live role-playing events over the last decade and involvement in hobby events over the last two decades.



## 14. FIREWORKS

We do not operate large firework displays at our events. On occasion we will include one or two small domestic fireworks or entertainers will provide displays of fire-breathing and fire-juggling. These activities are rare but always take place under close supervision by our stewards as well as Alison Pennington, the serving fire safety officer. Care is taken to keep the audience a safe distance away and emergency equipment is on hand to deal with any accidents.

## 15. FIRE SAFETY

The fire safety officer for our events is Alison Pennington, an extension of her responsibilities as the member of the management team responsible for the site. Assisted by former members of the fire service we have carried out a fire risk assessment for our events and implemented plans to reduce and control the risks. This plan is reviewed regularly and all members of the security team, stewards, marshals and game referees are given instruction around our fire safety protocols before each event.

## 16. POLICE

Due to the limited size of our events and the extremely low security issues they present, our risk assessment has concluded that it is not necessary to inform the local police services of our event plans. We have no need of any kind for dedicated policing at our events.

## 17. FOOD HYGIENE

We use five subcontractors to provide food for event attendees. Andrea Webley operates Feast a large caterer providing food to several hundred attendees throughout the event. Sean Maguire operates Mhorish, Chris Douglas operates Tyches, and William Hirst operates Wills Noodles - all of these are smaller operation that serve food to proportionally less people. Nicky Appleby operates the Appleby Coffee Company which sells snacks and hot drinks. All caterers possess level two food hygiene certification, safer food, better business, appropriate insurance and are registered with their local authority.

### **Facilities**

As already detailed, there is extensive toilet provision for all event attendees including the caterers. They have a temporary sink with running hot water and clean drinking water. Both caterers are provided with an electrical supply from our event electrical infrastructure.





## 18. ENVIRONMENTAL ISSUES

We believe that Tournament Stud is ideal for the events we operate there. The land is relatively flat but drains well. There is excellent tree cover from the installed tree lines and surrounding woodlands significantly reducing the impact of high winds.

The site is very close to the A43 an excellent road with good links to the local motorways. We are aware that events at the adjacent Silverstone grand prix circuit strain the local road networks but these events are literally hundreds of times the size of ours. We are careful not to run on weekends that they operate so that we do not add additional congestion at difficult times.

The character of the site is that is surround on two sides by trees, this is useful for us as it helps improve privacy at our events, but also serves to ensure that we can operate an event without anyone from the local community knowing that we are there.

### **Local Community Issues**

We have periodic contact with representatives of the local parish council. We have been running on the site for four years now. We are not aware of any incidents that have caused local residents distress during that time, although we check with them whenever they are in the area. We always encourage them to discuss any problems with us.

### **Waste Management**

We use Grundons to remove all our liquid waste and Dial-a-bin to remove all our dry waste. After an event is complete we have a team of volunteers who litter-pick the entire site removing all remaining waste. Keeping the site clean and tidy is essential for us, so that we can maintain the appearance of archaic England as part of our events.

### **Traffic Management**

Car sharing ratios for event attendees are extremely high, as many patrons travel long distances to reach the event. As a result the impact on traffic volumes is minimal. Our events are timed to discourage people arriving during rush-hour periods, to try to ensure that our customers are not delayed by congestion on the A43 at this time - this also helps to ensure that the majority of our vehicles arrive due offpeak hours for the road network.

### **Power**

We use a 67Kva generator hired from the local Paragon tool hire company. This is installed on site by Mark Bretherick, a fully qualified and experienced electrician who





is responsible for overseeing the safety of the electrical supply as it is distributed to toilets, showers, caterers, event administration facilities.

## Noise

The noise levels generated by our events are generally imperceptible to anyone more than a few hundred yards away. We don't use any amplified music or any amplification of any kind - as the modern character does not fit the atmosphere of the events we operate. We don't have stages and performers - the only noise is that made by a few hundred people moving around and talking.

Occasionally we have had brought in acoustic musicians for a special purpose, for instance we once employed a small Oompah band to perform for thirty minutes at the beginning of our event. This sound is audible to residents, but it is infrequent (rarely more than once a year), short in duration (musicians play for up to an hour before stopping) and is always produced entirely without electrical amplification.

## Weather

We keep a close eye on weather forecasts on the run up to, and throughout an event. Our three core risks are sun-stroke, high winds and cold. If weather forecasts indicate that the weather will be sufficiently inclement then we take steps to inform our event attendees and provide additional support to allow them to cope.

## Heat

Heat exhaustion and sun-stroke can be an issue for event attendees attending events in hot weather, particularly for those fighting in heavy armour such as mail or plate. Our battle referees have extensive experience of the risks involved and use sensible moderation strategies planning battles according to the weather, shortening battles where heat related injuries are a risk and ensuring there are adequate supplies of water.

## Wind

High winds represent a risk for event attendees. Poorly erected tents are at risk of movement. We monitor wind conditions carefully but we have a team of individuals (our site set-up team) who also check tents carefully before and during the event. Guy ropes are kept taught and pegs replaced if they work loose.

On two occasions we have operated events in 50mph winds. The risk to event attendees are raised dramatically at this point, but in both cases the winds have arrived after the event has begun. Attempting to take tents down during high winds, especially for inexperienced campers can be even more dangerous than leaving them up.



Consequently we operate an emergency stores system, keeping a large supply of ratchet straps and heavy steel pegs. When winds rise high enough that the event safety would be compromised, our teams apply additional securing too all the most vulnerable tents, using experienced people to ensure that the tents are as safe as possible.

If a tent cannot be made safe, then additional experienced crew are brought in to dismantle the tent. This is a high risk activity, it is only authorized to be carried out by our most experienced crew and only happens when the tent cannot be secured. The techniques used vary by tent, but usually involved removing the legs or supports from the tent (affected tents are almost invariably “party tents”) and dropping the roof of the structure to the ground.

This covers the event attendees belongings but allows the remaining structure to be lashed to the ground until the winds have abated and the tent can be dismantled or restored.

We are working to completely eliminate “party tents” and garden gazebos from our sites as these tents are invariably the tents identified as being at risk in high winds.

## **Cold**

Cold weather is a potential risk for our first event. To mitigate the issues in the past when unseasonably cold weather has hit an event we have provided space in a large communal heated tent for people to sleep in. We keep details and phone numbers for local hostelrys and help facilitate attendees moving from the site to the hostelry in situations where their own cold weather provision is inadequate.







# ODYSSEY

TAKE YOUR PLACE IN THE GREAT GAME

## RISK ASSESSMENT

### EVENTS 2014

**Risk assessment undertaken by:**

Matthew Pennington

**Signed:**

*Matthew Pennington*

**Date:**

13/3/2014

**Event Dates:**

Winter Solstice – 29<sup>th</sup> Mar – 1<sup>st</sup> Apr  
Spring Equinox – 24<sup>th</sup> May – 27<sup>th</sup> May  
Odyssey 1 – 14<sup>th</sup> Jun – 16<sup>th</sup> Jun  
Summer Solstice – 26<sup>th</sup> Jul – 28<sup>th</sup> Jul  
Odyssey 2 – 9<sup>th</sup> Aug – 11<sup>th</sup> Aug  
Autumn Equinox – 13<sup>th</sup> Sep – 15<sup>th</sup> Sep

**Open:**

All events begin at 1pm on the Friday of the event.  
Some participants arrive up to one day earlier. Set-up for crew only begins two days earlier.

**Break down:**

Begins at 3pm on the final day of the event, is completed at 7pm the following day.

**Event Director:**

Matthew Pennington

**Venue:**

Tournament Stud  
Syresham Fields Farm  
Biddlesden  
Brackley  
NN13 5TR

<http://www.tournamentstud.com/>

Mob: 07764824111

Tel: (01280) 851125

**Distribution:**

**Profound Decisions Management Team:**

Matthew Pennington (Event director)  
Bill Pennington (Site manager)  
Alison Pennington (Event administration)

**Event Safety Officer:**

Chris Butcher (Safety officer)

**All Profound Decisions senior crew:**

Tom Butterworth (Site set-up)  
Marc Fothergill (Site set-up)  
Aaron Johnston (Site set-up)  
Neil Dabson (Site set-up)  
Rick Clarke (Steward)  
Gavin Waller (Marshal)  
Steve Tiernan (Marshal)  
Mark Bretherick (Event electrics)  
Richard Wilson (Event electrics)  
Graeme Jamieson (Event referee)  
Paul Tucker (Event referee)  
Juliet Wilder (Weapon checking)  
Paul White (Weapon checking)  
Bill Thomas (Set design)  
Jim Thompson (Set design)  
Richard Lumb (First aid)



# PROFOUND DECISIONS

Professional Live Roleplaying

DFW





<p><b>Scope:</b> This risk assessment covers all four Profound Decisions Empire Events and both Profound Decisions Odyssey Events throughout 2014.</p>	<p><b>Drug Use:</b> <b>Alcohol:</b> Events are characterized by a sustained level of moderate drinking. It is very rare for individuals to become paralytically drunk, but very common for large numbers of attendees to be mildly inebriated by the evening. <b>Tobacco:</b> Tobacco is smoked at events, but usage is declining in line with the national picture. <b>Illegal Drugs:</b> Recreational use of illegal drugs is not unknown at live role-playing events. In general it is confined to cannabis. There are no indications of usage of other classes of drugs. Clear policies are in place to forbid the use of those recreational drugs that are illegal.</p>	<p><b>Attendee Profile:</b> All attendees are live role-players, the overwhelming majority of whom are drawn from the small tight-knit community of British live role-players. Less than 1% of attendees are from overseas; 4% of attendees are new to live roleplaying. Empire participants range from 5 to 75 years of age, and some parents being younger children to accompany them. The hobby includes a large number of students and former students. 1.75% are under 7 years of age. 0.75% are between 7 and 10 years of age. 2.25% are between 11 and 16 years of age. 0.4% of attendees have a substantial mobility issue, requiring sticks or a wheelchair to move around. Other disabilities are considerably less common. It is uncommon for expectant mothers to attend the event, with rarity increasing towards the end of the pregnancy. Odyssey participants range from 16 to 75 years of age. We do not allow young children to attend the event but crew and traders are allowed to bring a baby with them on the basis that their child remains outside the game area throughout the event.</p>
<p><b>Busiest Time:</b> The busiest time is the Friday that the event begins, as many participants prefer to arrive for the start of the event. Empire attendance reaches 1400 adult attendees, 75 children and 300 event volunteers over the course of a single event. Odyssey attendance reaches 300 adult attendees, 2 children and 150 volunteers.</p>	<p><b>Vulnerability to Terrorism and Protest:</b> There are no circumstances under which there would be any conceivable terrorist threat to the event. I am not aware of any live role-playing event run anywhere in this country ever incurring any form of protest at any point.</p>	
<p><b>After-show Events:</b> All attendees are required to leave site by 7pm of the final day of the event. When the site is clear the site set-up crew work to remove tents and clear the site. There is a party on this evening of every event, to reward the volunteers for their hard work and to give them an opportunity to relax. There are no other after-show events.</p>		



# 1. TRAFFIC MOVEMENTS ON SITE

Assessed Risk	Who might be harmed and how?	Level without Policies	Level with Policies	Further Action Required	Action by whom?	Action by when?	Completed
Vehicle collision with pedestrian.	Volunteers and public may suffer serious or even fatal injury.	Medium	Low	Observe vehicle movements around site	Security Team	Ongoing at all events.	
Vehicle to vehicle collision.	Volunteers and public may suffer potential injury.	Low	Low	None			
Vehicle collision with tent.	Volunteers and public may suffer serious or even fatal injury.	Medium	Low	Observe vehicle movements around site	Security Team	Ongoing at all events.	

## POLICIES IMPLEMENTED

### Gate reception

Profound Decisions operate a gate reception team led by Rick Clarke, who reports directly to the management team. Members of the gate team provide written briefs to every driver on the site vehicle policies (explained below) and direct the driver to a parking spot. Every member of the gate team is equipped with radio.

### Speed limit

Profound Decisions operate a 5mph speed limit everywhere on site.

### One way system

Profound Decisions operate a one-way system, circulating cars round the site, to avoid bottlenecks at narrow openings and avoid the need for cars to turn around on site.

### Restricted access

The event officially begins at 1pm on Friday and finishes at 3pm

on the last day of the event. Vehicles access to the main event site is prohibited except for emergencies during the event.

### Clear vehicle lanes

Tents are pitched adjacent to parked vehicles to ensure good separation between tents. The parking and camping area is laid out to ensure that clear vehicle lanes are left that also serve to keep tents more than 4m apart and keep moving vehicles away from tents.

### Vehicle Exclusion Zone

The main IC field is roped off and vehicles are excluded from this area. A wide vehicle lane surrounds this area delineated using ropes, to allow vehicles to drive around the IC field, *before the event starts*, without entering. If a vehicle must enter the IC field then it is escorted directly by a marshal to ensure speed is kept below 5mph and to keep participants clear.

Only emergency vehicles are permitted in the IC area once the event begins.

## CREW RESPONSIBLE

### Profound Decisions Management

Matt Pennington

### Security Team

Rick Clarke

Gavin Waller

Steve Tiernan

### All Members of the Security Team





## 2. POWER SUPPLY DISTRIBUTION

Assessed Risk	Who might be harmed and how?	Level without Policies	Level with Policies	Further Action Required	Action by whom?	Action by when?	Completed
Safety failure at generator.	Risk of electrocution for anyone operating the generator inappropriately.	High	Low				
Water contamination of electrical supply network.	Risk of electrocution for anyone operating electrical equipment on site.	Medium	Low	Protect all sockets with sealed waterproof boxes.	Mark Bretherick	June 2014	
Electrical faults with equipment.	Risk of electrocution for administration team, caterers and on site vendors.	Medium	Low	PAT testing across all equipment > 1yr old	Mark Bretherick	June 2014	
Damage to cables.	Risk of electrocution for electricians.	Low	Low				

### POLICIES IMPLEMENTED

#### Electrical team

All electrical connections are installed by members of the Profound Decisions electrical team, which is run by Mark Bretherick, a qualified and experienced electrician. They install all elements of the electrical power distribution network. A member of the electricians team is on duty with a radio throughout the event to respond to any immediate need to maintain the network.

#### Power generation

Power generation is from an 67kva commercial rated three phase generator. The generator is cordoned off with exclusion tape, no entry is permitted to anyone other than a member of the Profound Decisions management team or the electrical team. The unit includes a banded fuel tank designed to contain any potential fuel leak from the engine or tank.

#### Connections isolated

All extension cables are kept well clear of the ground to prevent ground water shorting the system. Where possible cables are struck from the walls of tents with cables coiled to prevent condensation running down the wires.

#### Earth load protection

Power is distributed from the generator to six separate distribution boxes. Each box includes RCD protection.

#### Visual Inspection of Equipment

All electrical equipment undergoes a visual inspection for loose cables or connections at the start of each event before being connected to the power supply.

### CREW RESPONSIBLE

#### Profound Decisions Management

Alison Pennington

#### Electricians Team

Mark Bretherick

Richard Wilson

Ara McBay

David McBride





### 3. FIRE RISKS

Assessed Risk	Who might be harmed and how?	Level without Policies	Level with Policies	Further Action Required	Action by whom?	Action by when?	Completed
Candles and coal fires in event marquees.	Event attendees caught in tent fire.	Low	Low				
Candles and BBQs in dome tents.	Event attendees caught in tent fire.	Medium	Low				
Fireworks, and fire poi, fire breathing, etc for displays.	Paraffin burns to participants and onlookers.	Low	Low				
Ground fires.	Unattended fires may spread to nearby tents used by event attendees.	Medium	Low	Construct new fire alters with raised rims	Event Participants	Easter 2014	

#### POLICIES IMPLEMENTED

##### Fire safety

Alison Pennington is the fire safety officer, on duty with a radio throughout the day. In the evening fire safety is handled by the security team. In the event of a fire, the incident would be assessed by the duty fire safety officer. They call the fire service if necessary; if it can be dealt with safely using available equipment they direct the efforts to deal with the fire. They direct crew to crew to ensure that a suitable safety exclusion zone is maintained around the fire.

##### Ground fire sites

Profound Decisions provide designated fire alters for ground fires. Site crew ensure that no-one is allowed to pitch a tent in close proximity to a ground fire. Members of the security team patrol the site throughout the event, with instructions to extinguish unattended fires.

##### Tent placement

Event attendees are directed where to pitch their tents by members of the site team under the supervision of Neil Dabson. Tents and marquees are pitched at least 4m apart to prevent a fire spreading to an adjacent tent and ensure easy access for emergency vehicle.

##### Fire displays

Event attendees are not permitted to use any fire works or to carry out any fire displays unless under the direct supervision of the duty fire safety officer. The fire safety officer directs the event crew to ensure that a sufficiently large exclusion zone is maintained around any fire display.

#### CREW RESPONSIBLE

##### Profound Decisions Management

Alison Pennington

##### Security Team

Rick Clarke

Gavin Waller

Steve Tiernan

##### All Members of the Security Team

27



## 4. LIVE ROLE-PLAYING INJURIES

Assessed Risk	Who might be harmed and how?	Level without Policies	Level with Policies	Further Action Required	Action by whom?	Action by when?	Completed
Injuries caused by blows from LRP weapons	Any participant in a battle could be bruised or cut by a weapon.	Medium	Low	Update safe weapon construction guidelines	Matthew Pennington	June 2014	
Crush related injuries caused by over-crowding in battles	Participants in the thick of fighting, could be crushed by over-crowding.	Low	Low				
Trips or falls caused by fighting near guy-ropes	Any event attendee	Medium	Low				

### POLICIES IMPLEMENTED

#### Weapon check team

Every LRP prop used in combats during the event is checked by a member of the weapon check team supervised by Juliet Wilder. Every weapon that is considered to be suspect is checked personally by Juliet Wilder. Weapons that do not meet Profound Decisions stringent safe construction standards are rejected and cannot be used at the event. Weapons that pass are marked with a visible tag.

#### Safe fighting

Profound Decisions issues every event attendee with easy-to-follow guidelines to ensure that risks during battles are minimised. Head shots are discouraged and strikes to the face, neck and groin are forbidden. Attendees are required to pull every blow and to avoid fighting while intoxicated. We use a teams of referees led by Graeme Jamieson and Paul Tucker who oversee large battles. The referees remove unsafe combatants from the battle. Every referee is equipped with a radio to allow them to coordinate battles.

#### Overcrowding

Crowds do not naturally form at events, except when large in-character battles take place. Referees act to stop any battle where participants are becoming sufficiently closely packed to present a crowding risk to each other. They also stop and relocate the battle if it moves too close to areas where footing is unsafe particularly near tents.

#### Crowd control

Every event attended is issued with crowd control rules, requiring them to instantly stop what they are doing if they hear the "Time-Out" emergency stop call. Any event attendee can give the emergency call if necessary, but the referees supervise the battle with express instruction to use the call if they have safety concerns. The emergency stop calls used by Profound Decisions are common throughout the LRP hobby and all experienced event attendees are accustomed to hearing and following the signals. Experience has proven that we are able to rapidly halt large melee battles featuring hundreds of participants using the call if safety considerations require it.

### CREW RESPONSIBLE

#### Profound Decisions Management

Matthew Pennington

#### Senior Referees

Graeme Jamieson

Paul Tucker

Nicholas Taylor

Richard Loveday

James Crollie

Emma Woods

#### Senior Weapon checkers

Juliet Wilder

Paul White

#### All Members of the Referee Team





## 5. FIRST-AID ISSUES

Assessed Risk	Who might be harmed and how?	Level without Policies	Level with Policies	Further Action Required	Action by whom?	Action by when?	Completed
Minor injuries need treatment on site.	Event attendees suffer minor cuts or bruises during the event.	Low	Low				
Severe injuries need rapid identification and appropriate treatment	Battle participants can suffer severe injuries, as can event attendees who trip or fall.	Medium	Low				
Event attendees may suffer alcohol intoxication.	Event attendees who have drunk excessively.	Low	Low				
Event attendees may suffer hypothermia.	All event attendees if the temperature drops below freezing.	Medium	Low	Purchase additional emergency blankets	Alison Pennington	Easter 2014	

### POLICIES IMPLEMENTED

#### First aid team

First aid cover is provided by a commercial first aid event services company managed by Richard Lumb. Their staff are equipped with radios allowing them to respond quickly to any injury. Injuries are assessed, minor injuries are treated at the first-aid station; any attendee with a severe injury is given appropriate treatment while an ambulance is called for.

#### Responsible driver

Event attendees whose injuries are sufficient to require hospital treatment but do not merit an emergency service response are taken to the nearest casualty department by car. If a friend is not available then a member of the first aid crew or a member of the Profound Decisions management team will drive them.

#### Incident recording

A full log is kept of all first aid incidents.

### Alcohol intoxication and hypothermia

Site security team patrol the event throughout the evening. If any individual is identified who is intoxicated or at risk of hypothermia they are relocated to the heated first aid station. The risk is assessed by the first aid team and if the risk is marginal they are kept under observation.

#### Medical notes

All event attendees submit details of any relevant medical notes for use by the first aid team during the event.

#### Emergency access

Site crew know to ensure that players leave sufficient emergency access lanes when pitching tents. They have the authority to move any tent which they feel would compromise emergency access routes. If an emergency service vehicle is required, then a member of the security team is posted at the gate to receive the vehicle and direct it to the incident by the most propitious route.

### CREW RESPONSIBLE

#### Profound Decisions Management

Matthew Pennington  
Alison Pennington  
Bill Pennington

#### First Aid Provision

Richard Lumb

#### Security Team

Rick Clarke  
Gavin Waller  
Steve Tierman

#### All Members of the Security Team





## 6. ERECTING MARQUEES SAFELY

Assessed Risk	Who might be harmed and how?	Level without Policies	Level with Policies	Further Action Required	Action by whom?	Action by when?	Completed
Marquee components falling on crew during erection or removal.	Site set-up crew erecting a marquee can be struck by the marquee if it falls.	Low	Low				
Marquees guy ropes coming lose during high winds.	Falling tents can potentially strike any event attendees.	Medium	Low				

### POLICIES IMPLEMENTED

**Tent erection and removal**

The site team erect several large marquees before the event begins. They are split into five teams, each of which has a designated supervisor who is charged with ensuring that sensible safety precautions are followed. Tents are not dropped while anyone is inside or within range of the descending poles. Team supervisors are instructed to call for sufficient additional assistance to raise or lower large marquees safely.

**High winds**

During high winds, members of the site team supervised by Alison Pennington patrol the site checking that all tents remain secure. They are equipped with radios allowing them to call for assistance if they discover a tent is no longer secure. They assess the situation, and direct the crew to re-peg the guy ropes if the tent can be made secure or to drop the tent if it cannot. Where tents brought by players have become insecure we provide additional pegs and storm guys to safely secure the tent or drop the tent if it cannot be made safe.

### CREW RESPONSIBLE

**Profound Decisions Management**  
Alison Pennington

**Site set-up Team**

- Chris Butcher
- Aarron Johnston
- Tom Butterworth
- Marc Fothergill
- Neil Dabson

**All Members of the Security Team**



## 7. FOOD HYGIENE

Assessed Risk	Who might be harmed and how?	Level without Policies	Level with Policies	Further Action Required	Action by whom?	Action by when?	Completed
Food Poisoning	Any event attendees can receive food poisoning from food that has not been stored, prepared or cooked correctly	High	Low				

### POLICIES IMPLEMENTED

#### Event catering

Profound Decisions allow five companies, Feast, Mhorish, Tyches, Wills Noodles, and Appleby Coffee to provide catering to players and crew at the event. The caterers have the appropriate food hygiene training and certification and follow standard safety such as the use of thermometers to ensure that meat is cooked right through. Their operations are overseen by Alison Pennington who ensures that standard food hygiene requirements are being met.

### CREW RESPONSIBLE

#### Profound Decisions Management

Alison Pennington

#### Caterers

Andrea Webley

Adrian Webley

William Hirst

Sean Maguire

Chris Douglas

Nicky Appleby



## 8. EVENT SECURITY

Assessed Risk	Who might be harmed and how?	Level without Policies	Level with Policies	Further Action Required	Action by whom?	Action by when?	Completed
Physical altercation.	Event attendees or volunteers could become embroiled in a physical altercation.	Low	Low				
Illegal drug use.	Event attendees may become unsafe while under the influence of illegal drugs, putting other event attendees at risk	Low	Low				

### POLICIES IMPLEMENTED

#### Security

Rick Clarke is the official head of the security team for the event. Rick is an SIA accredited security professional. His team of marshals offer 24 hour security for the event. All members of the security team are equipped with a radio at all times. Rick reports directly to the Profound Decisions management team.

#### Drug policy

Profound Decision's published rules state a very clear policy of no tolerance for illegal drugs use. Anyone discovered using illegal drugs would be immediately reported to the police.

#### Incident Log

We have a log ready to record a security incident if one occurs. I receive a full verbal report each morning from the security team of any incidents arising from the previous evening.

### CRWE RESPONSIBLE

#### Profound Decisions Management

Alison Pennington

#### Security Team

Rick Clarke

Gavin Waller

Steve Tiernan

#### All Members of the Security Team





## 9. WATER AND WASTE

Assessed Risk	Who might be harmed and how?	Level without Policies	Level with Policies	Further Action Required	Action by whom?	Action by when?	Completed
Clean drinking water.	Diarhoea and dehydration for all event attendees if they cannot access clean drinking water.	Medium	Low				
Clean toilets	Toilets can become contaminated if they are not kept clean	Low	Low				
Waste Disposal	Waste must be removed regularly to a safe central area to prevent build up of flammable materials on site.	Medium	Low				

### POLICIES IMPLEMENTED

#### Clean drinking water

Clean drinking water is available on the site drawn from the local mains supply and distributed through standpipes around the site.

#### Toilets

We are forecasting 1400 attendees for events this year. we have a total sanitation provision of fourteen unisex portaloos, 22 cubicles for women and 18 cubicles and 22 urinals for gents. From regular experience we know that this number is sufficient to meet the requirements of our event attendees.

#### Showers

For 1400 attendees we make nineteen showers available.

### Waste disposal

Profound Decisions have contracted Dial-a-bin to handle waste disposal for the event. They will supply two roll-on-roll-off twenty cubic yard covered skips for distribution around the site. They will collect the skips and dispose of the rubbish after the event.

### CREW RESPONSIBLE

**Profound Decisions Management**  
Alison Pennington



## 10. SEVERE WEATHER

Assessed Risk	Who might be harmed and how?	Level without Policies	Level with Policies	Further Action Required	Action by whom?	Action by when?	Completed
Storm damage to tents	Event attendees may be exposed to the climate if their tents are rendered unusable.	Medium	Low				
Hypothermia	Any event attendee without sufficient cold weather clothing or bedding is at risk of hypothermia if the event is unusually cold.						

### POLICIES IMPLEMENTED

#### High winds

High wind speeds can damage or destroy event attendees tents, leaving them without suitable accommodation. Profound Decisions have designated facilities that can be converted into emergency accommodation facilities if sufficient event attendees require it.

#### Cold

The first aid facility is heated to ensure that they are able to deal with individual cases of exposure to cold. If unseasonal weather conditions occur then Profound Decisions have designated facilities that can be converted into heated accommodation facilities if sufficient event attendees require it.

### Late cancellation indication

Profound Decisions monitor the weather forecasts carefully on the run up to every event to assess the potential need to cancel the event if the weather makes it unsafe to continue. We have the ability to email more than 95% of our event attendees up to one day before the event and to post messages on the company website at any time.

### CREW RESPONSIBLE

#### Profound Decisions Management

Matthew Pennington  
Alison Pennington  
Bill Pennington

#### First Aid Provision

Richard Lumb

#### Security Team

Rick Clarke  
Gavin Waller  
Steve Tiernan

**All Members of the Security Team**





## 11. WORKING AT HEIGHT

Assessed Risk	Who might be harmed and how?	Level without Policies	Level with Policies	Further Action Required	Action by whom?	Action by when?	Completed
Fall	Volunteers from the electricians and site set-up teams may be badly injured by a fall.	High	Low				

### POLICIES IMPLEMENTED

**Reduce working at height to a minimum**

All members of the teams are instructed to avoid work at height where possible. Site set-up team leaders are instructed to request authorization from Alison Pennington before attempting work at height.

**Ensure area is clear**

If there is no alternative to working at height, then a member of the site set-up team will be nominated to observe the area to ensure that access is restricted.

**Appropriate use of step ladders only**

The electricians team are authorized to use step ladders to secure elevated cables, as this work is low-risk and short duration. Commercial grade step-ladders with wide stable bases are provided.

### CREW RESPONSIBLE

**Profound Decisions Management**

Matthew Pennington  
Alison Pennington  
Bill Pennington

**Site Set-up Team**

Chris Butcher  
Tom Butterworth  
Marc Fothergill  
Aaron Johnston  
Neil Dabson

**Electricians Team**

Mark Bretherick  
Richard Wilson



ASL

Ashton, Kerryann

From: Jean Bardrick [redacted] >  
Sent: 16 July 2014 16:12  
To: Licensing Team  
Cc: Planning\_Enforcement  
Subject: Objection to 14/0092/LAPRE and S/2014/0801/FUL  
Attachments: AVDC and notices.pdf

Dear Sir/Madam,

Please see attached letter of objection for licensing application 14/0092/LAPRE and planning application for South Northants Council S/2014/0801/FUL.

Kind regards,

Ronald L Randall

Tel: [redacted]  
email: [redacted]

\*\*\*\*\*

This email and any files transmitted with it are confidential and intended solely for the use of the individual or entity to whom they are addressed. If you have received this email in error please delete it from your system.

This email does not constitute any form of contract.

This footnote also confirms that this email message has been swept by MIMESweeper for the presence of computer viruses.

Vat Number 447 1385 41

[www.clearswift.com](http://www.clearswift.com)

\*\*\*\*\*



# Biddlesden Park

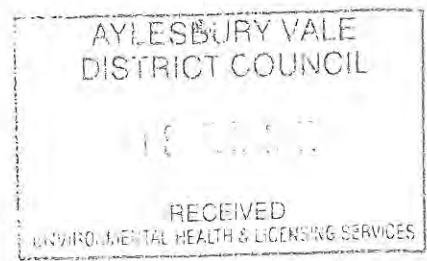

Licensing Services Manager  
Aylesbury Vale District Council  
The Gateway  
Gatehouse Road  
Aylesbury  
HP19 8FF

15 July 2014

Dear Sir/Madam

**Objection to:**  
**Aylesbury Vale District Council Ref: 14/00992/LAPRE and**  
**South Northants Planning Application: S/2014/0801/FUL**

I am writing to object strongly to the proposals outlined in the above applications.

Prior to this Application we are already experiencing considerable disruption to village life and I am sure that I speak on behalf of all the residents of Biddlesden. We have had major disruption caused by vehicles parking in the village when wet conditions made access to the proposed site very difficult. During these events we have experienced considerable mud on the road and because of the position of the site entrance on a sharp bend this has on occasions made the road very dangerous.

On numerous occasions we have experienced more than 1,000 people on site and the noise created by even the current activities has kept us awake until as late as 2.00 am.

In their application they state that they have no intention of changing the access to Syresham Fields Farm which clearly with a 1,000 vehicular movements over a 2 day period will create a major safety issue.

With so many people on site over a 48 hour period (or longer as currently some campers arrive the day before and do not drift away until late on the fourth day) to deal with that level of effluent would require a lot more than an opened top sewage container and a few port-a-loos. People have already been observed using the hedge lines when the queues to the amenities have been excessive.

In the application question No. 12 asks "Is your proposal within 20 metres of a watercourse" the answer no is not factually correct as the site that is used by the participants includes several ditches and a pond which are frequently overflowing with water. Also waste water from the showers appears to drain directly onto the ground which is often flowing down the access track towards the entrance for all to trample through causing more contamination. As the site is elevated above two of the seven streams that make up the River Ouse any long term seepage could damage the

AS8





existing water course. I do not believe that we should be considering any more applications as we have an abundance of these facilities already available at Silverstone. The existing sites around Silverstone Racecourse do not encroach on anybody's liberties or way of life. Silverstone recently has reduced or lost quite a few of the events held there that they have enjoyed in the past and I am sure that there are many camp site that would be happy to consider this type of activity. I have taken the time to make one or two enquiries and know that there are sites that would be happy to hold this type of event. These sites have substantial showers, toilets and hard standing in order to deal with all types of weather conditions.

This application is being made by Profound Decisions Ltd who rent the land for a small sum of money from the current owner who does not live on the site. This has all the hallmarks of a situation that will cause long term contamination and will completely disrupt the village life of Biddlesden which the majority of the residents have enjoyed for all of their lives. As there are other sites that could accommodate this activity in the local area with little or no disruption to local residents I strongly propose that you consider all of the objections before making a decision on this application.

Yours faithfully

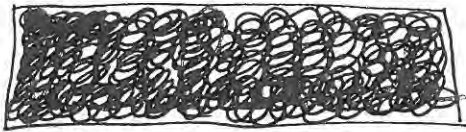

R L Randall

cc: South Northamptonshire Council  
Council Offices  
Springfield  
Towcester  
South Northamptonshire  
NN12 6AE

**URGENT**

Licensing Services Manager  
The Gateway  
Gaehouse Road  
Aylesbury  
HP19 8FF

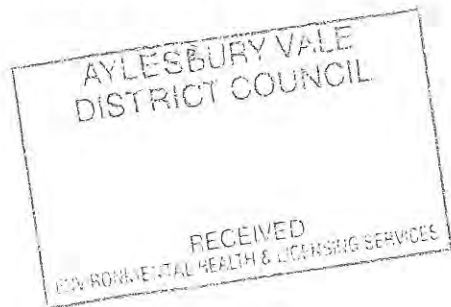

**By First Class Post and e-mail: [licensing@aylesburyvaledc.gov.uk](mailto:licensing@aylesburyvaledc.gov.uk)**

Our Ref : JZM/  
Your Ref : 14/00992/LAPRE  
Date : 22 July 2014

Dear Sir / Madam

**Syresham Fields Farm, Biddlesden, Brackley NN13 5TR ("the Farm")  
Application for Premises Licence 14/00992/LAPRE dated 26 June 2014 ("the Application")**

We have been instructed by Mr Ronald Randall in respect of the Application.

**Background**

Mr Randall is the registered proprietor and occupier of Biddlesden Park, Biddlesden, Northamptonshire, NN15 5TR ("Our Client's Property"). Our Client's Property is situated in the locality of the application site.

We note that our client has already set out his initial concerns with the Application by letter dated 15 July 2014.

Whilst we emphasise the concerns and comments contained in our client's letter of objection (and do not wish to repeat the same in these representations), we have been instructed to formally object to the Application on behalf of our client for the additional reasons detailed below.

We also enclose a copy of our letter to South Northamptonshire Council concerning our client's objection to the application for planning permission also made by the applicant, Profound Decisions Ltd ("the Applicant"), dated 2 April 2014. As the Authority will note, it is apparent that this planning application has been made to facilitate the activities proposed under the Application.

**The Application**

We note from the Application that the Applicant seeks a premises licence to permit the following activities on the Farm that includes until 1am on Thursday, Friday, Saturday and Sunday:

1. Opening of the Farm to members of the public;
2. Live Music; and

LEICESTER · MANCHESTER · MILTON KEYNES  
NORTHAMPTON · NORWICH

### 3. Sale of alcohol and provision of late night refreshments ("the Activities").

#### Our client's concerns

Under The Licensing Act 2003 ("the Act") we understand that the Authority may only grant the Application if it complies with the "licensing objectives". Section 4 (1) of the Act confirms the objectives to include: "*(a) the prevention of crime and disorder; (b) public safety; (c) the prevention of public nuisance; and (d) the protection of children from harm*".

It is clear that the Application is contrary to these objectives and, by granting the Application, these objectives shall not be met.

The Application does not specify the numbers of attendances anticipated to attend these events, although we understand that previous events ran by the Applicant (comprising of activities now subject to the Application) have secured attendances of over 1000 people.

With such levels of attendance, this is likely to result in several hundred vehicle movements over a one or two day period. Such vehicles may include cars, but also larger vehicles required to transport goods and materials to the Farm during the setting up of each event. It is clear that the existing rural highway network has insufficient capacity to deal with such intense levels of traffic and, consequently, the adverse impacts in highway terms would be significant and unjustified.

We also understand that during previous events, many attendees have been forced to park their vehicles in the nearby village of Biddlesden, particularly during periods of rainfall when the current access to the Farm becomes unusable. We consider that these highway concerns in isolation would warrant a refusal of the Application on the grounds of public safety.

Our client is also understandably concerned that the nature of the events will inevitably lend itself to significant impacts on the amenity of local residents in terms of noise. We are informed that previous events of this type have caused unacceptable disturbance to our client and a number of local residents, when activities are continuing until late into the night or early hours of the morning.

These activities have resulted in music, canon fire, lighting of camp fires and large crowds of people re-enacting mock battles. It is clear that such nuisances cannot be properly mitigated against and thus the application ought to be rejected on grounds of crime and disorder and public nuisance.

The Farm also includes a number of watercourses and ditches which are located in close proximity to the proposed area for toilets and washroom facilities. We must therefore emphasise our client's concerns in this regard in respect of the risk of contamination in the River Ouse.

Further, whilst we note that the Applicant has suggested that the portable toilets and amenities shall be securely stored and emptied off-site, we understand that this has not been common practice to date, where waste and refuse has been stored on the Farm itself for considerable periods of time following conclusion of events. The Application should again be rejected on grounds of public safety and nuisance.

#### Next Steps

It is clear that the adverse impacts of the Activities do not meet the licensing objectives under section 4 of the Act. Therefore, we consider that it is only appropriate for the Authority to reject the Application.



However, whilst we maintain that the Application must be rejected, if the Authority is minded to grant permission, we consider that any permission ought to be properly conditioned in attempt to deal with the highway, environmental and amenity concerns detailed above.

We look forward to receiving confirmation that the Application has been refused and should be grateful for an acknowledgment of this letter in the meantime.

Yours faithfully



Howes Percival LLP

**From:** [REDACTED]  
**Sent:** 06 July 2014 11:57  
**To:** Licensing Team  
**Subject:** APPLICATION FOR PREMISES LICENCE - PROFOUND DECISIONS LTD., SYRESHAM FIELDS FARM, BIDDLESDEN, NN13 5TR

Dear Sir/Madam

I am writing to oppose the above application on the following grounds:

1. I have lived in Biddlesden for over 24 years. The area is a farming community, a conservation area. Our house in Biddlesden backs directly onto Syresham Fields Farm. The farm has traditionally been a working arable farm, with several public rights of way across and around the farm.
2. As I understand it, Profound Decisions have no ownership interest in the farm or the area (they are based in Preston – see <http://www.profounddecisions.co.uk/aboutus?7>). The owner of the farm has allowed Profound Decisions to run several events each year at this farm. These events are changing the nature of the Biddlesden community and area, and have the following effects:
  1. Each event attracts several hundred vehicles. There are only two ways in to the farm, both run right through the Biddlesden parish.
  2. There are no footpaths in Biddlesden and no street lighting. The only public rights of way in Biddlesden cross Syesham Fields farm or run around the farm boundary. When these events are running, our access to the rights of way are often challenged by security staff at these events. Local residents feel reluctant to use footpaths that have existed for decades because on-site security staff immediately challenge any of us who venture onto these paths during the events or during event setup. Organisers have now taken to putting a closed gate across the main public footpath, and use a sign asking people to phone them for access (we have a photograph of this) - surely they should not be allowed to block a public right of way?
  3. The noise from these events affects our normal living in this rural area. The nature of these events involves live music, battles, canon fire, large crowds shouting battles cries etc. The events go on in to the early hours of the morning. The noise continues as several hundred people continue to drink, have fires etc. into the early hours. Last month (June) our son had 'A' level exams and was kept awake until after 4am on two nights running by the noise coming from these events. The application itself is seeking permission for the provision of late-night refreshment; this clearly supports the late night aspect of these events.
3. The events use portable toilet buildings with sewage stored in a large open steel skip on the main field – is this appropriate?
4. On occasions when we have had rain during these events, the mud created on our village roads forms several hundred cars leaving the venue has not been cleared up; we have simply had to live with it (our local farmers on the other hand are quick to clear up any dirt they create on our road). In addition, when rain has been heavy, many event visitors then start to park in the road in Biddlesden, adding to the disturbance.
5. The events are often based around public holidays, so residents have the increased traffic, noise etc. during their holiday weekends.
6. In our view, the use of the farm has now been changed without permission. The focus of the farm, the use of existing farm buildings on the farm, the permanent storage of materials, buildings etc. on the farm are now all linked to the events and not to the operation of a working farm.
7. The owners of the farm have not made any attempt to inform Biddlesden residents of any of these events. What started as isolated events with individual temporary licenses has turned into 4-5 events per year, and the Profound Decisions website now lists this venue for all of their events – this surely represents a change in use of this farm.
8. The events are open registration, and people can turn up and pay on the day – there is therefore no practical limit to the size of these events.

In my view the farm is no longer a working farm, but has become an events business. I therefore oppose this application.



Steve Gilroy



## Ashton, Kerryann

---

**From:** [REDACTED]  
**Sent:** 15 July 2014 10:42  
**To:** Licensing Team  
**Subject:** re Profound Decisions Ltd -application for premises licence-objection by 22/07/2014 reference number 14/00992/LAPRE attention of Aston Kerryann

**Importance:** High

### OBJECTION

#### Planning history of the site

It is my understanding that in a 6 months period the Company making the application (Profound Decisions Ltd) have received permission to use the site for 28 days during their tenancy to hold events. This has been exceeded every year since their occupation 3-4 years ago. The erection of tents etc starts at least 5 days before each event, the event takes place over 3 days and they take usually 3 days to clear part of the site i.e. approximately 11 days. Usually 4 events are held each year thus totalling 44 days-well in excess of the allowed period.

As stated above I wrote that the site was cleared in part. The site is not cleared in entirety. A number of marquees and large props are left standing for the next event. This year the marquees were left for months until they were blown down by the wind posing a danger to all persons and animals passing. No checking or correction was ever done. For some years the large prop structures were left standing all winter .

As you can see from the plans the site ostensibly consists of a large field in front backed by a smaller one to the rear . The former is currently used for car parking and food provision the latter to hold the event. In addition a wood on 2 sides of the smaller field is also used to hold events.

The large field car park/camping area is in the past year been used to host events, the woods have in the Spring many carpets of Bluebells these are trampled by the event goers. The large field is undulating and very slippery in wet weather. The smaller field soil is clay ,boggy and slippery if there is any rain. Indeed at the last event held in early June the event goers were banned from using the smaller field for health and safety reasons.

#### Parking ,access highway safety and Crime and disorder

Parking in the large field is very difficult and dangerous in wet weather due to bogging. At the June event many of the event goers parked on the narrow road through Biddlesden village.. The site entrance is on a very sharp dangerous bend, Mud covered the road surface. Despite telephone calls to the police regarding the dangerous conditions no action was taken by the them, The Highway Agency or Bucks County Council. Many event goers parked in front of residents houses with the usual noise and inconvenience.

During the night of each event , there are 1-2 'security 'persons at the main gate. On enquiry I was told threats were made to destroy the sites property and harm the participants. Indeed over the period of 3-4 years property was stolen of some value. We do not want any violence to persons or property which was brought about by the holding of events on this site

I would mention that at Glastonbury and Milton Keynes Bowl no liquids are allowed at any events in case of alcoholism as well as for commercial reasons. In addition if an accident does occur the nearest hospital is the Horton (14 miles, 23 minutes distant) or Milton Keynes General (19 miles, 31 minutes distant) maybe too late to save a life.

#### Control of pollution and noise

As the site is above 2 of the 7 streams feeding the river Ouse any long seepage could damage the existing water course .

The events staged by Profound Decisions Ltd have since they started some 3-4 years ago with a large increase in attendees. As evidence one need only look at the company accounts ,available to public view on the Companies House website. Turnover for the year ended 31/12/2013 £309846 and 31/12/2012 £171048 an increase of £138798.

Profound Decisions Ltd list the Syresham Fields Farm venue as their only one. The event is getting larger each year, the figures of 1000 persons and 600 cars have been mentioned per event, at least 4 times per annum. At the last event due to the wet weather, the event was moved to the larger field, nearer to the village residents. The noise of the event kept residents awake to 2am and in some cases even longer. This is not an isolated occurrence as bad weather has often occurred in past years with the same results.

#### Conclusion

The site is totally unsuitable for the holding of an event of this type. It is too near the village of Biddlesden, the access road is too narrow and the volume of traffic too large being concentrated at the start and finish of the event. Most village residents have lived there in excess of 25 years, this event has only been in place 3-4 years so that it cannot be said that they became resident after the events commenced. All residents are utterly opposed to the consolidation of the planning regulations. I also suggest you consult your colleagues at AVDC to take into account the application of a premises licence (provision of alcoholic drink etc.)

There are better facilities near the Silverstone racetrack with safer access and wet weather provision. If a permanent planning application is successful and Aylesbury Vale District Council agree to a drinks licence the residents will be faced with years if not for the foreseeable future a site with permanent planning permission to hold noisy, disruptive and potentially dangerous events.



R Kay



**From:** [REDACTED]  
**Sent:** 15 July 2014 13:34  
**To:** Ashton, Kerryann  
**Subject:** 14/00992/LAPRE

Biddlesden Parish Meeting OBJECTS to the above application.

At our recent Parish Meeting it was unanimously agreed to object to this application on the basis of preventing a public nuisance, protecting children from harm, obstruction of public rights of way, and public health and safety.

This application is for a licence for music, sale of alcohol and late night refreshments at events at Syresham Fields Farm.

A Public Footpath AZ46 runs right through this site and is currently obstructed by items stored thereon. Additionally, when items are brought onto/ removed from the area, a considerable amount of damage is caused to the surface of the land making it totally unsuitable for pedestrian use, another cause for obstructing the Right of Way. Furthermore, a 'new' stile erected on the line of the footpath is, apart from being inaccessible due to obstructions, totally inadequate in design and usability by all but the most able bodied walkers. Surely these days a pedestrian gate is more in keeping with current policy for access to the countryside. Indeed, the previous owners installed kissing gates when diverting the nearby footpath AZ45. The proposal states that no diversion of a public right of way is involved, the current right of way must therefore be reopened and kept clear. There have been occasions when the gates across the drive to Syresham Fields, and consequently the footpath, have been locked with no alternative pedestrian access to the right of way.

The application states that there is no provision for the storage of waste but sewage collection equipment is stored on site, including open topped containers used for sewage storage. A major concern is the health risk involved with storing sewage in an open container which, although regularly emptied, always has some residue left from event to event. Similarly, a number of disused 'porta-loos' have been dumped in the middle of the field for several weeks. We consider this a real health hazard.

The application claims the site is not visible from a public road or public footpath. Having made a separate application because of the footpath that runs through the middle of the proposed site, regardless of the other surrounding rights of way, we find this misleading to say the least and the site is clearly visible from public roads on two sides, especially in winter when it would be full of equipment being stored and the absence of foliage allows these items to be seen. In fact many consider it to be a complete eyesore inflicted on us by people who live far away and do not have to live with the mess they leave behind.



This application is to facilitate the running of events which cause severe disruption and nuisance to people living nearby. Upwards of 1000 'players' attend these events where 'opposing armies' battle each other with much shouting, singing, chanting etc until the early hours of the morning. Residents are unable to leave bedroom windows open at night or enjoy peaceful evenings in their gardens. Generators used to provide power on site also contribute to the noise pollution. Noise has been known to continue until 4.00am.

Public accounts show that Profound Decision's annual turnover has increased from £170k to £309k in the last year, an over 80% increase in activity. We fear further expansion if this application is granted. The activities have already moved nearer the neighbouring housing, increasing the level of nuisance.

This year, construction started on the 'catering venues' on 7th April and structures will remain, given last year's example, until November/December, far in excess of the '28 day rule'. These are sizeable constructions with white canvas roofs which can be seen from a considerable distance despite being behind a hedgerow.

During wet weather, some of those attending park on the narrow lane through the village, even outside people's homes, causing obstruction to villagers and through traffic. With over 1200 people attending these events, many coming and going frequently during their stay, the amount of traffic using the entrance on a blind corner is substantial and earlier this year the mud carried out onto the road was literally running down the road through the village. Despite drawing concerns to the attention of 'officials' on site, and reassurances that action would be taken, nothing was done. There is a real danger of accidents when coaches and mini-buses park on the corner to load/unload passengers and all their equipment. This is a major safety issue.

The presence of such numbers of very strangely attired and fearsome looking 'warriors' camped at close proximity to the public footpath deters adults and families from using the rights of way on two sides of the site, one of which is a Bridleway.

Detritus left behind from 'camp fire cooking' and left-over meals deposited in hedgerow bottoms and even the open fields has caused more than one inquisitive dog to suffer unpleasant consequences of a quick snack. The propensity of open fires on the site gives rise to fears of fire spreading out of control. There seems to be little evidence of fire prevention or control measures in place outside of the main administration tents.

The shower blocks appear to have drainage direct onto the ground underneath them and this results in a stream of 'grey water' which makes its way down the access track towards the entrance gate for all attendees to pass through on their way into the site. Whilst there is no water course within the storage application site, the event site has many ditches and at least one pond which cannot help but be contaminated.

We consider this shows adequate cause to believe that granting this licence will contribute towards allowing a threat to Public Health and Safety, both on site and on the adjoining roads, will create a Public Nuisance and fails to protect our children from intimidation and fear.

For all of the above reasons we feel that this application should be REFUSED

Regards,



P Miller

**Ashton, Kerryann**

---

**From:** [REDACTED]  
**Sent:** 16 July 2014 23:31  
**To:** Licensing Team  
**Subject:** Fw: Application14/00992/LAPRE. Syresham Fields Farm.

----- Forwarded [REDACTED]  
**From:** [REDACTED]  
**To:** "[licensing@aylesburyvale.gov.uk](mailto:licensing@aylesburyvale.gov.uk)" <[licensing@aylesburyvale.gov.uk](mailto:licensing@aylesburyvale.gov.uk)>  
**Sent:** Wednesday, 16 July 2014, 23:18  
**Subject:** Application14/00992/LAPRE. Syresham Fields Farm.

2, Biddlesden.  
NN13 5TR.

We are a very quiet rural area, so even without amplification, the music which accompanies the invasion of people to Profound Decisions events , brings with it much volume of noise and intrusion over numerous days and nights. Much of the late night/early morning "singing" , which can be heard in our houses, is no doubt fuelled by drinks from The Tavern.

These are family events and we often find families in the village, parked in their cars, seeking refuge from the late night revelry, on site not being suitable for their children.

The provision of late night refreshment only reiterates the encouragement of parties well into the small hours and the further use generators. Already their sound grinding on and on, hour after hour, night after night, is really not acceptable. We are sure no local commercial business would get away with such noise pollution.

No indication is given as to what constitutes late nights but from previous experience of Profound Decision events this head well towards dawn !

We therefore strongly oppose this application, especially as by its very location, it would be open to gate crashing third parties in search of late night alcohol and refreshment.

Alan and Carole Muddiman.



**Ashton, Kerryann**

---

**From:** [REDACTED]  
**Sent:** 15 July 2014 17:00  
**To:** Licensing Team  
**Subject:** 14/00992/LAPRE

I write to oppose this application for a permanent late night refreshment, alcohol and music licence.

This event has taken place under a temporary licence for a number of years. Over this period the number of events has increased, as has the numbers attending, now over 1000 people per event, beyond the scope of a temporary licence, coming and going over 4 or 5 days. The noise has also increased with 'battles, singing and shouting going on until the early hours of the morning, causing disruption to people in the village.

The traffic also causes disruption to people as the entrance to the site is on a sharp bend on a narrow country lane unsuited to this volume of vehicles. In wet conditions the mud which comes off the site causes danger to vehicles and pedestrians.

The site is never cleared between events leaving a 'blot on the landscape' of what has always been a rural farming community.

This has become a large event business unsuited to this site, changing the nature of our way of life.

I suggest that AVDC liase with South Northants as the area used is in both counties. There is a separate application to SNDC for a storage facility, again in the middle of farmland and encroaching on a public footpath.

The activities now constitute a Public Nuisance and pose a risk to Health and Safety and therefore the application should be refused.

Yours sincerely

Mrs P Miller

[REDACTED]





**FREE Animations for your email - by IncrediMail!**

**Click Here!**

14 July 2014

Karen Thomas  
Licensing Applications  
AVDC  
The Gateway  
Gatehouse Road  
Aylesbury  
Bucks  
HP19 8FF

Dear Ms Thomas

RE: Licence Application No 14/00992/LAPRE.  
Syresham Fields Farm, Biddlesden.  
Profound Decisions Ltd.

I strongly oppose the above application for the following reasons:

The village, which I have lived in for over 50 years has been disrupted and spilit by the events held by Profound Decisions Ltd.

The noise created at such events is disruptive, with total disregard for the views of local people.

Alcohol would only further increase the noise and disruption.

At no time have the local community been consulted or informed when events are to take place.

Organisers arrive up to a week beforehand and leave several days after the event, these people also cause a lot of noise and disruption.

Vehicular access is via one road only, causing noise pollution and traffic chaos, a permanent music licence would encourage the events to become ever larger.

I would ask that you carefully consider the noise, and disruption to our rural community, which until profound Decisions Ltd, who are based in Preston, arrived with their increasingly larger events was peaceful and a lovely place to live. This peace and tranquillity is now a thing of the past I fear.

Yours sincerely

  
M P Beecher

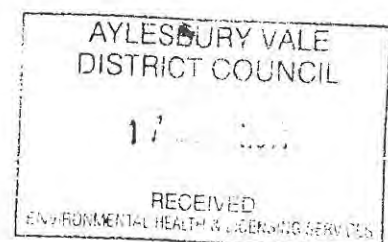

A72

15 July 2014

Karen Thomas  
Licencing Applications  
AVDC  
The Gateway  
Gatehouse Road  
Aylesbury  
Bucks  
HP19 8FF

Dear Ms Thomas

Re: Premises Licence Application No: 14/00992/LAPRE.  
Syresham Fileds Farm, Biddlesden, NN13 5TR.  
Profound Decisions Ltd.

As you can see from my address I live in Biddlesden, my property backs onto Syresham Fields Farm, and is one field away from the area concerned.

I object to the licence being granted on what I believe is to be a permanent basis, the event organisers having had several temporary licences for their increasingly large events.

1/ When the events take place the noise is continuous into the early hours of the morning, disturbing local residents. Noises consisting of shouting, music, cannon fire, singing loudly, etc can be heard consistently with little regard for those residents who need to work the next day, have exams, or are ill, to name but a few scenarios. When locals complain to the organisers promises of action are very rarely followed by a mutually satisfactory resolution. Issuing a permanent licence would considerably disrupt our village.

2/ The tavern, where presumably the alcohol is dispensed, has been erected on the site since the 10/04/14, is this legal under temporary licensing laws??? Again a disregard on the part of Profound Decisions Ltd for the local community and licensing regulations.

3/ As you know the property concerned lies on the boundary of Bucks/Northants, a planning application has been submitted to South Northants Council for retrospective permanent storage for the site, indicating that along with the licence application above, Profound Decisions Ltd are proposing to hold events on an ever more regular basis, causing our community to be disrupted on a regular basis and our countryside decimated regularly by the sheer size of the events (at least 1,000 people at some events). I understand that an alcohol licence would be granted at the tavern, on the proviso that a maximum of 499 persons are in there at any one time, who will police this, will it be safe?

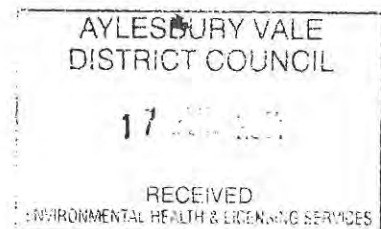

A73



4/ Profound Decisions Ltd state in their terms and conditions that each tent/camper will be able to use an oil drum to light a fire in, the implications of this following alcohol consumption, is somewhat daunting. As we live on the border of the county our nearest fire station is Buckingham, at least 15 minutes away, should a fire occur I fear for the consequences. What risk assessments are carried out, what are the health and safety implications, and what provisions are in place for any such occurrences?

5/ The access to the property is via one road only, the sheer volume of traffic to the site when events are taking place is enormous, emergency vehicle access needs to be considered.

6/ Due to the nature of the application, there is potential for disturbance due to excessive alcohol consumption, incurring the attendance of police, health services etc, who will pay for these services, I certainly hope the residents of Biddlesden will not pay via an increase in council tax??

I reiterate I strongly object to the issuing of an alcohol and music licence at Syresham Field Farm.

Yours sincerely

A large black rectangular redaction box covering the signature area.

E M R Beecher

## Ashton, Kerryann

---

**From:** [REDACTED]  
**Sent:** 19 July 2014 23:11  
**To:** Licensing Team  
**Subject:** Premises License Application: Profound Decisions Ltd @ Syresham Fields Farm  
**Attachments:** Syresham Fields Farm Premises License Woodpeckers Response.doc

Thank you for the opportunity to comment on the application for a permanent Premises License for the licensable activities of provision of live acoustic music (without amplification), provision of alcohol from a medieval tavern and provision of late night refreshment from Syresham Fields Farm, Biddlesden, NN13 5TR.

The application is made by Profound Decisions of Preston to support their business in providing Role Play events on the Buckinghamshire portion of the farm. Of note the permanent buildings of the farm are actually located across the county border in South Northamptonshire.

I regret I have not been able to view the application on-line despite information on the public notice (LA18 (11/05)) suggesting that this is possible, please accept my apologies if the points I make are appropriately covered in the application.

The events by Profound Decisions are undertaken on agricultural land, there is no medieval tavern and indeed there should be no permanent structures on the affected site. Consequently I am surprised that a Premises License application has been made where there are no legal premises. Many buildings are left on the site and are not removed between events, but I believe this contravenes current planning regulations. I am not aware of any application, successful or otherwise, for the change of use from agricultural land to another designation such as B2 (General industrial), D2 (Assembly and leisure) or Sui Generis that might support a permanent License.

There is however an application being made of South Northamptonshire for a change of use for a part of the farm from agricultural to B8 (storage), the application asks for an enormous area to be designated as storage (S\2014\0801\FUL) for which the consultation closed on 17 July 2014.

The number of events staged by Profound Decisions was initially few each year, with small numbers of attendees. In recent years the event has escalated both in number per year (about 5, typically over bank holidays and Easter) and in size (well over a thousand attendees) and on reflection this will be why Profound Decisions is making this application – the scale of the events outstripped the provisions allowed using the Temporary Event Notice route some time ago.

The events have become located closer to the village for reasons that escape me and combined with the increased footfall, have become very noisy - the clamour lasting well into the early hours (chanting, singing, battle cries and occasionally with fireworks being set off).

Biddlesden village is situated on a small country road. The traffic through the village both in the lead up to events and during them is very heavy, and on occasion vehicles are parked around the entrance to the site which is situated on a very sharp bend. Mud is carried from the fields onto the roads leading away from the site, further increasing the collision risk by affecting the grip on the road surface causing a significant skid risk.

Unfortunately there has been no liaison between the business or its representatives and the village, which might have had the effect of mitigating the issues outlined by allowing the business the opportunity to put remedial measures in place. There is no warning, no discussion and no contact. There exists a considerable risk that the event size which is already beyond a reasonable capacity will continue to grow unchecked in size and number, blighting the lives of residents.

I therefore strongly object to the license application by Profound Decisions on the basis that the event size and number already run have been outside that permissible with no regard for the character of the location or local residents, that the business is run from agricultural land that does not have the appropriate permissions in place for this type of business and even when granted temporary licenses from temporary premises the group have displayed a complete disregard for the conditions attached making it impossible to have confidence in their compliance with their obligations on a permanent basis.

Once again, thank you for the opportunity to comment,

Mark Borthwick





## Ashton, Kerryann

---

**From:** [REDACTED]  
**Sent:** 21 July 2014 20:51  
**To:** Licensing Team  
**Subject:** Planning Application No : 14/00992/LAPRE - Syresham Fields Farm, Syresham, NN13 5TR.  
**Attachments:** AVDC planning objection.docx

Dear Sir/Madam,

Re: Planning Application No : 14/00992/LAPRE - Syresham Fields Farm, Syresham, NN13 5TR.

The above Planning Application needs to be viewed in conjunction with Planning Application No: S/2014/0801/FUL going into South Northamptonshire Council. The site is situated across both Counties but it is crucial they are view together

I am writing to strongly object to the above application(s) on the following grounds:

- 1) I moved to Biddlesden five and a half years ago to raise my family in the peace and tranquility of a picturesque countryside location. Our home, and many of the others in Biddlesden, back on to Syresham Fields Farm, where these events are being held. The events themselves are taking place one field away from our house, not more than 100 meters away. I have found the increasing scale and frequency of the re-enactment events held at Syresham Fields, by Profound Decisions, very distressing. I have young children and I do not feel comfortable going on our usual walks around the various public rights of way going through and around the grounds where the event is held. This is a great shame.
- 2) Profound Solutions have been holding these events using a temporary, 28 day, license. In my view this is currently being breached - a weekend event will involve people on site for up to a week before and a week after the event. There loud parties and drinking during this time, on top of the organised nights of the actual event.
- 3) Biddlesden residents get no notification of the calendar of events for the year or the schedule of the re-enactments (to be aware when the disruptive noise was going to take place to be able to put animals inside and explain to children what is happening). The events are such an eyesore now, and the participants quite intimidating to look at, that I would be tempted to either not invite friends and family to my house on those weekends or to go away for the weekend. Again not ideal when we are talking about my family home.
- 4) Since the events have started a few years ago the growth has been alarming and there appears to be no limit to where this could go when you consider the two applications above on conjunction with one another – application for a large storage space, live music and alcohol licence.
- 5) The main focus of the events also used to be in the next field along, but this now seems to have moved to the field directly next to Biddlesden. The participants have always camped in the field adjacent to Biddlesden but rather than just occupying one end of the field, near Biddlesden, they now stretch the whole length of the field down to the farm. Again showing how the events have grown.
- 6) Direct disruption to Biddlesden, the majority of which will only be worsened with the influence of alcohol:
  - a. **Noise.** This starts early on in the week during the build up to the events at the weekend. Not just through construction, but loud parties at night. The events themselves are also incredibly intrusive with shouting, singing, bangs, music and chants. When the late night battles stop, it seems the party starts and goes well on into the night. We have been woken up on numerous occasions due to the noise and have also been unable to eat outside in the garden during the summer.

- b. **Visual.** The site is an eyesore for the majority of the year, to what extent just depends on the time between events. It is important to point out that the only time all the portable toilets, storage containers, caravans and other equipment are actually totally removed from the site of the event, is for a few over the Winter. The site looks even worse when it rains because the vehicles churn up the field which takes months to repair.
  - c. **Dangers.** With the volume of traffic greatly increased, and as already mentioned when the weather is bad (which is often is), the field is totally churned up and this mud is spread across the road all the way through Biddlesden. There has never been any attempt at cleaning this up which is dangerous and unsightly. On occasions cars have parked in Biddlesden to avoid the possibility of getting stuck in the field. Aside from being highly dangerous, this is clearly unacceptable as it is outside our house and where Villagers park. Other dangers include tents being allowed fires (rather than just the 'official' fires in communal areas) and rubbish/food/human waste left after the events. This is a real danger to children and animals.
  - d. **Vehicles.** The number of vehicles going through Biddlesden (this is the only way to access Syresham Fields) is unmanageable. The road is normally a quiet country lane, but is turned into a noisy, busy and dangerous road.
- 7) In my view these events, and their associated applications, is a change of land use from a working Farm to events/entertainment.
- 8) Finally, Profound Decisions are not based on site, in Biddlesden or nearby and so have no real interest in the local area or community beyond its commercial gain directly to them. This is not a solid base to move forward from.

Due to all the points above I believe strongly that Profound Solutions should not be granted Premises Licence and I therefore oppose this application.

Nick McKenzie

**Ashton, Kerryann**

---

**From:** [REDACTED]  
**Sent:** 21 July 2014 19:57  
**To:** Licensing Team  
**Cc:** [REDACTED]  
**Subject:** Syresham Fields Farm Application  
**Attachments:** AVDC Syresham Fields Farm.doc

Syresham Parish Council wish to lodge the attached letter as an objection to the premises licence application for the above farm in Biddlesden.

Best regards

Lesley Sambrook Smith

[REDACTED]



## Syresham Parish Council

**Chairman:** Mrs. Dorothy Dunkley 31 Wappenham Road Syresham Brackley NN13 5HQ  
Tel. 01280 850626

**Parish Clerk**  
Mrs. Lesley Sambrook Smith  
29B Bell Lane  
Syresham, Brackley  
Northants NN13 5HP  
01280 851178  
Email: [parishclerk@syresham.com](mailto:parishclerk@syresham.com)

21<sup>st</sup> July 2014

### **Notice of Application for Premises Licence, Syresham Fields Farm**

Dear Sir/Madam,

I am writing to fully support and endorse the residents of Biddlesden's concerns over granting a premises licence to Syresham Fields Farm.

Yours sincerely,

Lesley Sambrook Smith  
Clerk to the Parish

A80





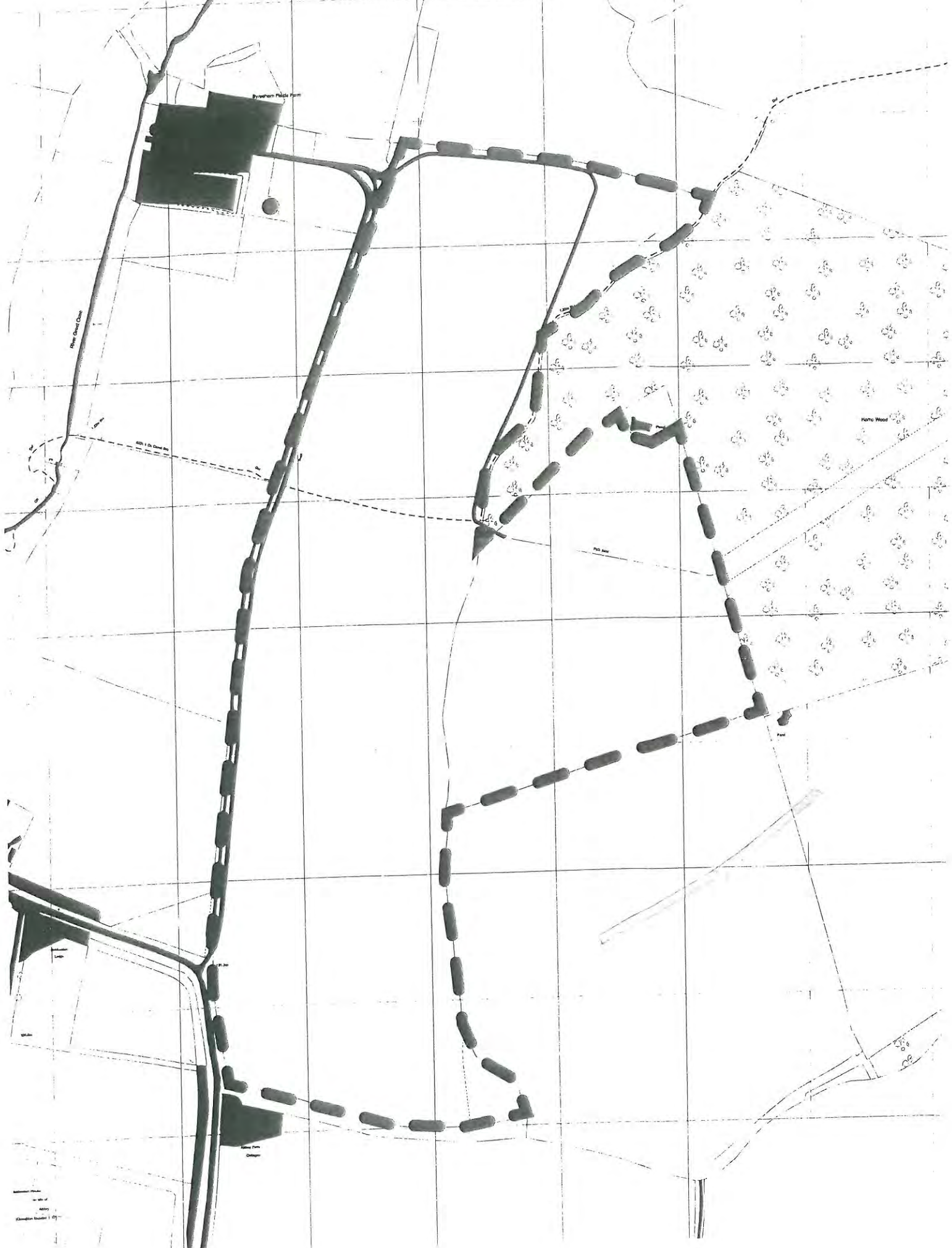

A82



# Tavern Floor Plan

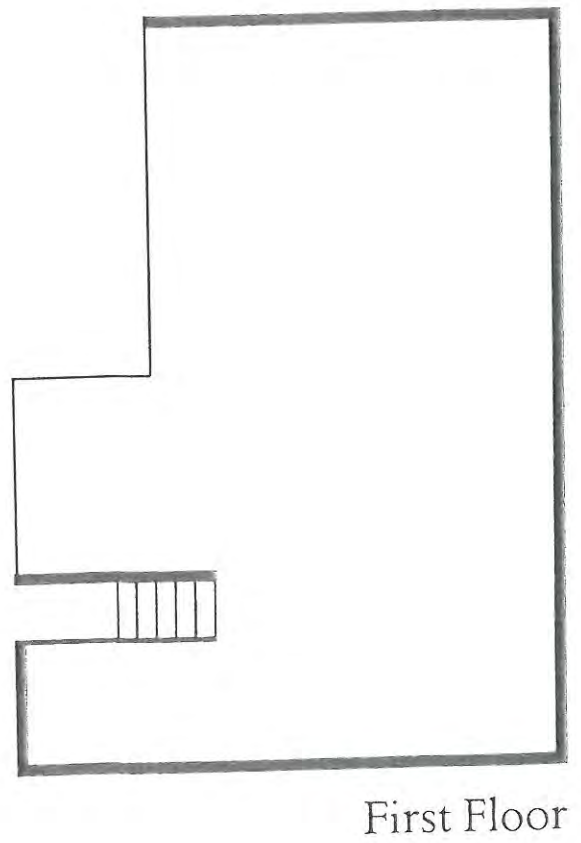
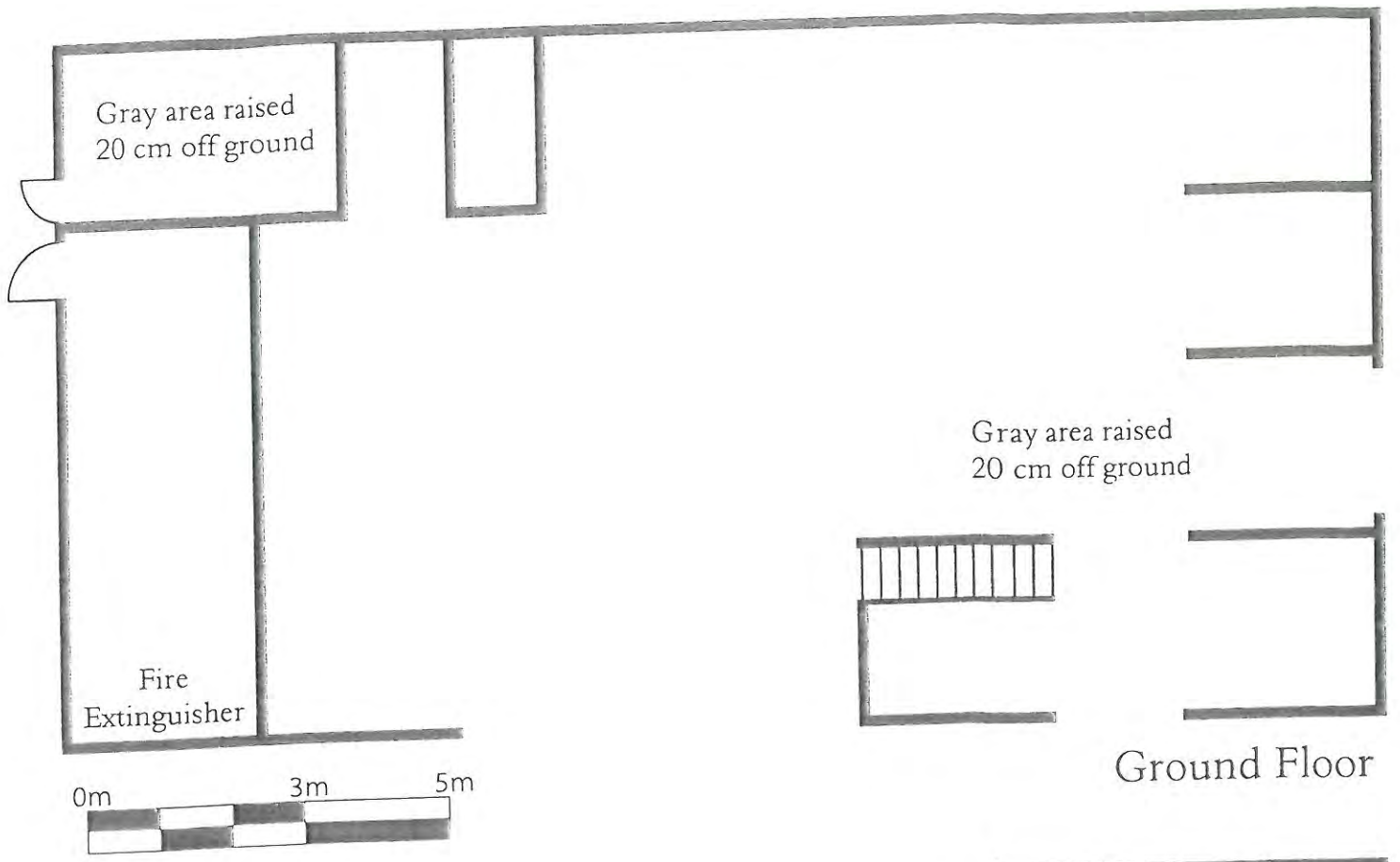

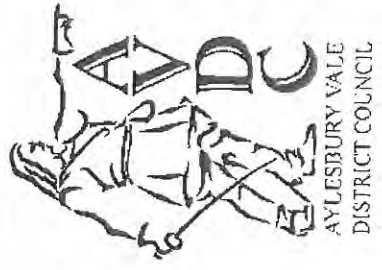

**Profound Decisions  
Syresham Fields Farm  
Biddlesden**

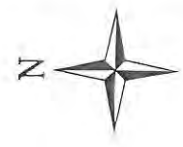

1:7,500

This map is reproduced from Ordnance Survey material with the permission of Ordnance Survey on behalf of the Controller of Her Majesty's Stationery Office © Crown copyright. Unauthorised reproduction infringes Crown copyright and may lead to prosecution or civil proceedings. 100019797 2014

